

Call Miles Supply for GS Diamant tooling

**Miles  
Supply**  
milessupply.com

**GS**  
DIAMANT  
DIAMOND TOOLS

**Catalogo Generale** *General Catalogue*





In GS Diamant, la nostra parola d'ordine è qualità, per questo abbiamo sempre selezionato le migliori materie prime per realizzare i nostri utensili diamantati.

Utilizziamo prodotti di prima qualità certificati per garantire i migliori risultati e prestazioni dei nostri prodotti.

Il valore aggiunto dell'azienda però è certamente dato dal contributo umano, le nostre maestranze mettono in campo tutto il valore della manualità e dell'artigianalità, unite al progresso tecnologico.

Il nostro Staff infatti segue percorsi di formazione in modo da essere sempre aggiornato sulle nuove tecnologie, sicurezza e tendenze del mercato.

*At GS Diamant, our motto is quality, and for this reason we have always selected the best raw materials for our diamond tools.*

*We use first quality products certified to guarantee the best results and the best performance for our products.*

*The company's added value, however, is without doubt the contribution of its human resources, our workers who bring all the values of manual skills and craftsmanship into play, combined to technological progress.*

*In fact, our staff follows training programs so as to be always up to date with new technologies, safety measures and market trends.*







## Sommario *Summary*

		SINTERIZZATE <i>SINTERED</i>	ELETTRODEPASTE <i>ELECTROPLATED</i>
Azienda <i>Company</i>		<b>9</b>	
Frese e Foretti <i>Routers</i>		<b>F-1 / F-11</b>	<b>F-12 / F-17</b>
Mole <i>Diamond wheels</i>		<b>M-1 / M-9</b>	<b>M-10 / M13</b>
Dischi <i>Blades</i>		<b>D-1 / D-5</b>	<b>D-6 / D-7</b>
CNC (Frese) <i>CNC Routers</i>		<b>C-1 / C11</b>	<b>C-12 / C-21</b>
CNC (Mole) <i>CNC Diamond wheels</i>		<b>C-22 / C25</b>	<b>C-26 / C-29</b>
Prolunghe <i>Extensions</i>		<b>P-1 / P-9</b>	
Lucidatura <i>Polishing</i>		<b>L-1 / L-3</b>	

## Legenda *Key to symbols*

Per granito	<i>For granite</i>	GR
Per marmo	<i>For marble</i>	MR
Per materiali tecnici	<i>For technical materials</i>	TM
Per ceramica	<i>For ceramic</i>	K











## Azienda Company

GS Diamant opera nel settore dell'utensileria diamantata da oltre 15 anni. L'azienda nasce nel 1999 quando il titolare Giaconi Sauro, avvalendosi della collaborazione di uno Staff fatto di persone e tecnici di alto profilo, crea la GS Diamant.

Grazie alla presenza di tali figure, offriamo al Cliente un valido servizio in ogni fase, dalla progettazione fino alla realizzazione completa e all'assistenza.

L'azienda si dedica con interesse all'aggiornamento tecnologico e al rispetto della sicurezza applicata al nostro settore, per essere all'avanguardia per attrezzature, macchinari e strumentalizzazione.

Il connubio tra qualità dei prodotti e assistenza pre e post vendita, hanno garantito nel tempo un percorso di sviluppo e crescita costante.

*GS Diamant has been operating in the diamond tools sector for more than 15 years. The company was founded in 1999, when the proprietor Sauro Giaconi created GS Diamant, rooting the company on the cooperation of staff made up of highly skilled people and technicians.*

*Thanks to the presence of such staff, we offer our customers an excellent service at every stage, from planning to the completion of the project and after sale service.*

*The company is committed to keep up to date with technology and to the respect of safety applied to our sector, to be at the forefront in terms of equipment, machinery and instrumentation.*

*The combination of the quality of our products and our before and after sale service has ensured a steady growth and development over time.*



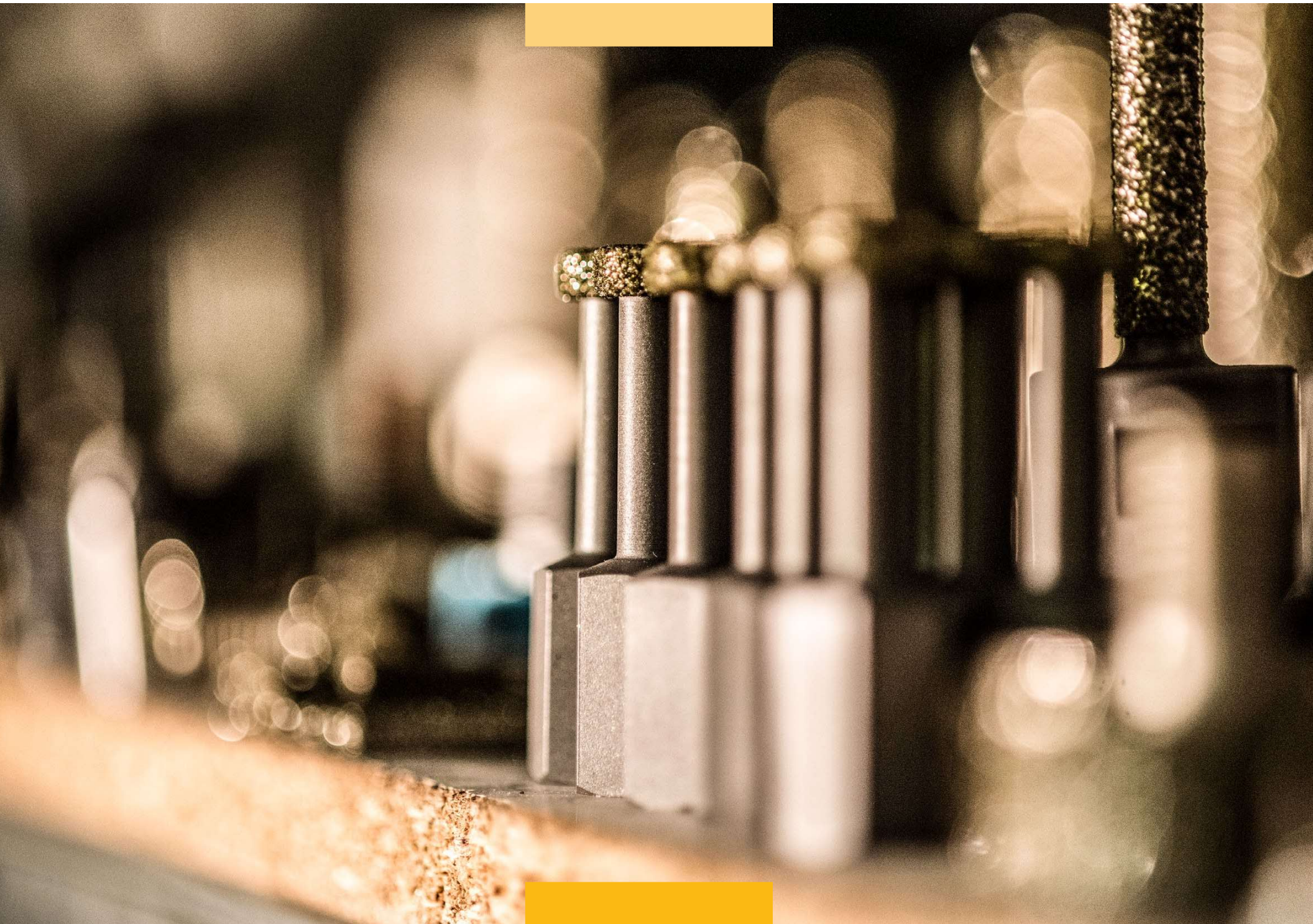



# Frese e Foretti *Routers and Drills*

Frese e foretti per il taglio, la sagomatura e la foratura di marmo, granito, materiali ceramici, pietre naturali ed agglomerati, sia per macchine manuali che a controllo numerico.

*Routers and drills for cutting, shaping and boring of marble, granite, ceramic materials, natural stone and composite materials, both for hand and numerical control machines.*



# — Frese Foretti *Routers and Drills* —



GR

## FRESA TIPO BLU PER GRANITO E AGGLOMERATI

### FINGER BIT BLUE TYPE FOR GRANITE AND ENGINEERED STONE

	COD	Ø	H	RPM	FEED
FCB	FCB0001635Z4	16	35	5000-6000	250-500 mm/min
	FCB0001645Z4	16	45		
	FCB0002035Z5	20	35		
	FCB0002045Z5	20	45	4500-5500	250-500 mm/min
	FCB0002035Z6	20	35		
	FCB0002045Z6	20	45		
	FCB0002335Z5	23	35	4500-5500	250-500 mm/min
	FCB0002345Z5	23	45		
	FCB0002335Z6	23	35		
FCB0002345Z6	23	45			

### CON SETTORE IN TESTA / WITH SEGMENT IN THE BOTTOM

	FCBS	COD	Ø	H	RPM	FEED
		FCBS001635Z4	16	35	5000-6000	250-500 mm/min
		FCBS001645Z4	16	45		
		FCBS002035Z5	20	35		
		FCBS002045Z5	20	45	4500-5500	250-500 mm/min
		FCBS002035Z6	20	35		
		FCBS002045Z6	20	45		
		FCBS002335Z5	23	35	4500-5500	250-500 mm/min
		FCBS002345Z5	23	45		
		FCBS002335Z6	23	35		
		FCBS002345Z6	23	45		
		FCBS002345Z6	23	45		



GR

## FRESA TIPO ROSSO PER MATERIALI MOLTO DURI

### FINGER BIT RED TYPE FOR VERY HARD MATERIALS

	FCR	COD	Ø	H	RPM	FEED
		FCR0002035Z5	20	35	4500-5500	200-400 mm/min
		FCR0002045Z5	20	45		
		FCR0002035Z6	20	35		
		FCR0002045Z6	20	45	4500-5500	200-400 mm/min
		FCR0002335Z5	23	35		
		FCR0002345Z5	23	45		
		FCR0002335Z6	23	35	4500-5500	200-400 mm/min
		FCR0002345Z6	23	45		

### CON SETTORE IN TESTA / WITH SEGMENT IN THE BOTTOM

	FCRS	COD	Ø	H	RPM	FEED
		FCRS002035Z5	20	35	4500-5500	200-400 mm/min
		FCRS002045Z5	20	45		
		FCRS002035Z6	20	35		
		FCRS002045Z6	20	45	4500-5500	200-400 mm/min
		FCRS002335Z5	23	35		
		FCRS002345Z5	23	45		
		FCRS002335Z6	23	35	4500-5500	200-400 mm/min
		FCRS002345Z6	23	45		

F-2

FRESE SINTERIZZATE  
SINTERED ROUTERS

# — Frese Foretti *Routers and Drills* —



GR

## FRESA TIPO ORO PER TAGLIO VELOCE GRANITO

### FINGER BIT GOLD TYPE FOR GRANITE FAST CUT

	COD	Ø	H	RPM	FEED	
FCO	FCO0002035Z8	20	35	4500-5500	400-650 mm/min	
	FCO0002045Z8	20	45			
	FCO0002335Z8	23	35	4500-5500	400-650 mm/min	
	FCO0002345Z8	23	45			

### CON SETTORE IN TESTA / WITH SEGMENT IN THE BOTTOM

	FCOS002035Z5	20	35	4500-5500	400-650 mm/min	
	FCOS002045Z5	20	45			
	FCOS002335Z5	23	35	4500-5500	400-650 mm/min	
	FCOS002345Z5	23	45			



TM

## FRESA TIPO GIALLO PER MATERIALI TECNICI

### FINGER BIT YELLOW TYPE FOR TECHNICAL MATERIALS

	COD	Ø	H	RPM	FEED	
FCY	FCY0002025Z5	20	25	4500-5500	125-300 mm/min	
	FCY0002035Z5	20	35			

K

## FRESA TIPO ARANCIO PER CERAMICA

### FINGER BIT ORANGE TYPE FOR CERAMIC

	COD	Ø	H	RPM	FEED	
FCA	FCA0002025Z5	20	25	4500-5500	150-350 mm/min	
	FCA0002035Z5	20	35			

F-3

FRESE SINTERIZZATE  
SINTERED ROUTERS



# — Frese Foretti *Routers and Drills* —



GR

## FRESA PER TAGLI INCREMENTALI PER GRANITO

### INCREMENTAL STEP CUT BIT FOR GRANITE

	COD	Ø	H	CONNECTION	RPM	FEED
FTI	FTI002015M10	20	15	M10	4800-5500	400-1000 mm/min
	FTI002015M12	20	15	M12		
	FTI002015M14	20	15	M14		
	FTI002515M12	25	15	M12	4800-5500	400-1000 mm/min
	FTI002515M14	25	15	M14		
	FTI003015M12	30	15	M12	4800-5500	400-1000 mm/min
	FTI003015M14	30	15	M14		



GR

## FORETTO A SETTORI PER MARMO/GRANITO

### SEGMENTED DRILL FOR MARBLE/GRANITE

	COD	Ø	H utile	RPM	FEED
FSM	FSMG00020100	20	100	2800-3500	60-120 mm/min
	FSMG00020200	20	200		
	FSMG00025100	25	100		
	FSMG00025200	25	200	2500-3000	60-120 mm/min
	FSMG00030100	30	100		
	FSMG00030200	30	200		
	FSMG00035100	35	100		
	FSMG00035200	35	200		
	FSMG00040100	40	100	2000-2500	50-100 mm/min
	FSMG00040200	40	200		
	FSMG00050100	50	100		
	FSMG00050200	50	200	1800-2000	50-100 mm/min
	FSMG00060100	60	100		
	FSMG00060200	60	200		
	FSMG00080100	80	100		
	FSMG00080200	80	200		
	FSMG00090100	90	100		
	FSMG00090200	90	200		
	FSMG00100100	100	100		
	FSMG00100200	100	200		
	FSMG00120100	120	100		
	FSMG00120200	120	200		
	FSMG00150100	150	100	1300-1500	25-55 mm/min
	FSMG00150200	150	200		
	FSMG00200100	200	100		
	FSMG00200200	200	200		

F-4

FRESE SINTERIZZATE  
SINTERED ROUTERS

# — Frese Foretti *Routers and Drills* —



GR

## FORETTO A CORONA CONTINUA PER GRANITO

### CONTINUOUS RIM CORE DRILL FOR GRANITE

	COD	Ø	RPM	FEED	
FKG	FKG000000655	6	2800	35-40 mm/min	
	FKG000000855	8			
	FKG000001055	10			
	FKG000001255	12	2500	35-40 mm/min	
	FKG000001555	15			
	FKG000002055	20			
	FKG000002255	22	2200	35-40 mm/min	
	FKG000002555	25			
	FKG000003055	30			
	FKG000003255	32	1250	35-40 mm/min	
	FKG000003555	35			
	FKG000004055	40			
	FKG000005055	50	1100	35-40 mm/min	
	FKG000006055	60			

GR

## FORETTO A CORONA CONTINUA PER GRANITO PER MACCHINA MANUALE

### CONTINUOUS RIM CORE DRILL FOR GRANITE FOR MANUAL MACHINE

	Ø	ATT. M14	ATT. 5/8"	
FKGM	6	FKGM14000655	FKG58F000655	
	8	FKGM14000855	FKG58F000855	
	10	FKGM14001055	FKG58F001055	
	12	FKGM14001255	FKG58F001255	
	15	FKGM14001555	FKG58F001555	
	20	FKGM14002055	FKG58F002055	
	22	FKGM14002255	FKG58F002255	
	25	FKGM14002555	FKG58F002555	
	30	FKGM14003055	FKG58F003055	
	32	FKGM14003255	FKG58F003255	
	35	FKGM14003555	FKG58F003555	
	40	FKGM14004055	FKG58F004055	

F-5

FRESE SINTERIZZATE  
SINTERED ROUTERS



# — Frese Foretti *Routers and Drills* —



GR

**FORETTO A CORONA CONTINUA PER GRANITO ATTACCO ESAGONALE**

**CONTINUOUS RIM CORE DRILL FOR GRANITE HEXAGONAL CONNECTION**

	COD	Ø	H	
FKGAE	FKGAE0002055	20	55	
	FKGAE0002555	25	55	
	FKGAE0003055	30	55	
	FKGAE0003555	35	55	
	FKGAE0004055	40	55	
	FKGAE0005055	50	55	



TM

**FORETTO A CORONA CONTINUA PER MATERIALI TECNICI**

**CONTINUOUS RIM CORE DRILL FOR TECHNICAL MATERIAL**

	COD	Ø	RPM	FEED	
FKY	FKY000000655	6	4500-5000	15-30 mm/min	
	FKY000000855	8			
	FKY000001055	10			
	FKY000001255	12	3000-3500	15-30 mm/min	
	FKY000001555	15			
	FKY000002055	20			
	FKY000002255	22			2800
	FKY000002555	25	2500	15-30 mm/min	
	FKY000003055	30	2000-2200	15-30 mm/min	
	FKY000003255	32			
	FKY000003555	35			
	FKY000004055	40			1800
	FKY000005055	50	1100-1250	15-30 mm/min	
	FKY000006055	60			

**F-6**

**FRESE SINTERIZZATE**  
SINTERED ROUTERS

# — Frese Foretti *Routers and Drills* —



TM

**FORETTO A C.C. PER MATERIALI TECNICI PER MACCHINA MANUALE**

**C.R. CORE DRILL FOR TECHNICAL MATERIALS FOR MANUAL MACHINE**

	Ø	ATT. M14	ATT. 5/8"
FKYM	6	FKYM14000655	FKY58F000655
	8	FKYM14000855	FKY58F000855
	10	FKYM14001055	FKY58F001055
	12	FKYM14001255	FKY58F001255
	15	FKYM14001555	FKY58F001555
	20	FKYM14002055	FKY58F002055
	22	FKYM14002255	FKY58F002255
	25	FKYM14002555	FKY58F002555
	30	FKYM14003055	FKY58F003055
	32	FKYM14003055	FKY58F003055
	35	FKYM14003555	FKY58F003555
	40	FKYM14004055	FKY58F004055
	50	FKYM14005055	FKY58F005055
	60	FKYM14006055	FKY58F006055



TM

**FORETTO A CORONA CONTINUA PER MATERIALI TECNICI ATTACCO ESAGONALE**

**CONTINUOUS RIM CORE DRILL FOR TECHNICAL MATERIAL HEXAGONAL CONNECTION**

	COD	Ø	H
FKYAE	FKYAE0002055	20	55
	FKYAE0002555	25	55
	FKYAE0003055	30	55
	FKYAE0003555	35	55
	FKYAE0004055	40	55
	FKYAE0005055	50	55

F-7

**FRESE SINTERIZZATE**  
SINTERED ROUTERS



# — Frese Foretti *Routers and Drills* —



K

## FORETTO A CORONA CONTINUA PER CERAMICA

### CONTINUOUS RIM CORE DRILL FOR CERAMIC

	COD	Ø	RPM	FEED
FKA	FKA00000655	6	4500-5000	15-30 mm/min
	FKA00000855	8		
	FKA00001055	10		
	FKA00001255	12	3000-3500	15-30 mm/min
	FKA00001555	15		
	FKA00002055	20		
	FKA00002255	22	2800	15-30 mm/min
	FKA00002555	25	2500	15-30 mm/min
	FKA00003055	30	2000-2200	15-30 mm/min
	FKA00003255	32		
	FKA00003555	35		
	FKA00004055	40	1800	15-30 mm/min
	FKA00005055	50	1100-1250	15-30 mm/min
	FKA00006055	60		



K

## FORETTO A CORONA CONTINUA PER CERAMICA PER MACCHINA MANUALE

### CONTINUOUS RIM CORE DRILL FOR CERAMIC FOR MANUAL MACHINE

	Ø	ATT. M14	ATT. 5/8"
FKAM	6	FKAM1400655	FKA58F00655
	8	FKAM1400855	FKA58F00855
	10	FKAM14001055	FKA58F001055
	12	FKAM14001255	FKA58F001255
	15	FKAM14001555	FKA58F001555
	20	FKAM14002055	FKA58F002055
	22	FKAM14002255	FKA58F002255
	25	FKAM14002555	FKA58F002555
	30	FKAM14003055	FKA58F003055
	35	FKAM14003555	FKA58F003555
	40	FKAM14004055	FKA58F004055
	50	FKAM14005055	FKA58F005055
60	FKAM14006055	FKA58F006055	

F-8

FRESE SINTERIZZATE  
SINTERED ROUTERS

# — Frese Foretti *Routers and Drills* —



K

**FORETTO A CORONA CONTINUA PER CERAMICA ATTACCO ESAGONALE**

**CONTINUOUS RIM CORE DRILL FOR CERAMIC HEXAGONAL CONNECTION**

	COD	Ø	H	
FKAAE	FKAAE0002055	20	55	
	FKAAE0002555	25	55	
	FKAAE0003055	30	55	
	FKAAE0003555	35	55	
	FKAAE0004055	40	55	
	FKAAE0005055	50	55	



GR

**TESTINA INTERCAMBIABILE A SETTORI PER FORETTO**

**SEGMENTED CHANGEABLE HEAD FOR DRILL**

	COD	Ø	H utile	RPM	FEED
TFI	TFI000005050	50	50	DA VALUTARE A SECONDA DEL TIPO DI LAVORAZIONE TO BE ASSESSED ACCORDING TO THE TYPE OF PROCESSING	
	TFI000006550	65	50		
	TFI000008050	80	50		
	TFI000010050	100	50		

F-9

**FRESE SINTERIZZATE**  
SINTERED ROUTERS



# — Frese Foretti *Routers and Drills* —

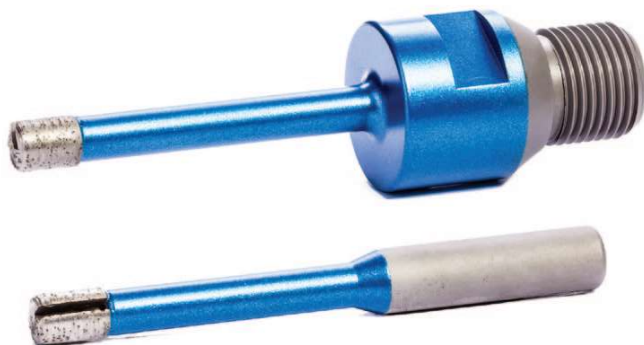

GR MR

## FRESA MANGIATUTTO ATTACCO ½ GAS

### MANGIATUTTO BIT WITH ½ GAS CONNECTION

	COD	Ø	H utile	RPM	FEED
FMGM	FMGMG0000550	5	50	6000	30-35 mm/min
	FMGMG0000650	6	50		
	FMGMG0000850	8	50		
	FMGMG0001050	10	50	5800	25-30 mm/min
	FMGMG0001250	12	50		
	FMGMG0001450	14	50	5500	20-25 mm/min
	FMGMG0001550	15	50		
	FMGMG0002050	20	50		
	FMGMG0003050	30	50	4500	15-20 mm/min

## FRESA MANGIATUTTO ATTACCO CILINDRICO

### MANGIATUTTO BIT WITH CYLINDRICAL CONNECTION

	COD	Ø	H tot	RPM	FEED
FMG	FMG000004706	4	70	6200	25-30 mm/min
	FMG000005706	5	70	6000	30-35 mm/min
	FMG000006706	6	70		
	FMG000008708	8	70	5800	25-30 mm/min
	FMG000107010	10	70		
	FMG000127010	12	70	5500	20-25 mm/min
	FMG000157010	15	70		



GR MR

## FRESA SGOCCIOLATOIO ATTACCO ½ GAS

### DRAINBOARD METALLIC BIT WITH ½ GAS CONNECTION

	COD	Ø	r	POS	RPM	FEED
FGS	FGS00010R5P1	10	5	1	6000-6800	400-600 mm/min
	FGS00010R5P2	10	5	2		
	FGS00010R5P3	10	5	3		
	FGS00010R5P4	10	5	4		
	FGS00012R6P1	12	6	1		
	FGS00012R6P2	12	6	2		
	FGS00012R6P3	12	6	3		
	FGS00012R6P4	12	6	4		
	FGS0015R75P1	15	7,5	1		
	FGS0015R75P2	15	7,5	2		
	FGS0015R75P3	15	7,5	3		
	FGS0015R75P4	15	7,5	4		

F-10

FRESE SINTERIZZATE  
SINTERED ROUTERS

# — Frese Foretti *Routers and Drills* —

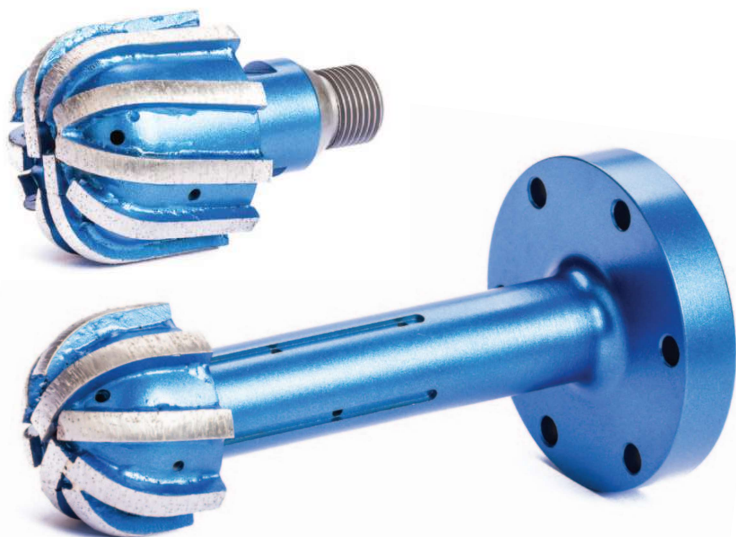

GR MR

## FRESA PER LAVELLI ATTACCO ½ GAS

### BIT FOR SINK WITH ½ GAS CONNECTION

	COD	Ø	r	L	H utile	RPM	FEED
FLSG	FLSG502050100	50	20	50	100	4500-5200	600-1000 mm/min eat 1-5 mm
	FLSG502050200	50	20	50	200		
	FLSG852050100	85	20	50	100	4200-4800	500-850 mm/min eat 1-5 mm
	FLSG852050200	85	20	50	200		

## FRESA PER LAVELLI ATTACCO FLANGIA

### BIT FOR SINK WITH FLANGE CONNECTION

	COD	Ø	r	L	H utile	RPM	FEED
FLSF	FLSF502050100	50	20	50	100	4500-5200	600-1000 mm/min eat 1-5 mm
	FLSF502050200	50	20	50	200		
	FLSF852050100	85	20	50	100	4200-4800	500-850 mm/min eat 1-5 mm
	FLSF852050200	85	20	50	200		

F-11

FRESE SINTERIZZATE  
SINTERED ROUTERS



# — Frese Foretti *Routers and Drills* —



GR

## FRESA CILINDRICA ELETTRODEPOSTA CON ATTACCO CILINDRICO

### ELECTROPLATED CYLINDRICAL BIT WITH CYLINDRICAL CONNECTION

	COD	Ø	H	ATT. Ø	L TOT	RPM	FEED
FCC	FCC000410670	4	10	6	70	6000-8000	250-600 mm/min
	FCC000620670	6	20	6	70		
	FCC000630680	6	30	6	80		
	FCC000820880	8	20	8	80		
	FCC000830880	8	30	8	80		
	FCC010201080	10	20	10	80		
	FCC010301080	10	30	10	80		
	FCC010301090	10	40	10	90		

GR

## FRESA CILINDRICA ELETTRODEPOSTA CON ATTACCO 1/2 GAS

### ELECTROPLATED CYLINDRICAL BIT WITH 1/2 GAS CONNECTION

	COD	Ø	H	RPM	FEED
FCE	FCE000001030	10	30	7000-10000	250-620 mm/min
	FCE000001040	10	40		
	FCE000001230	12	30		
	FCE000001240	12	40		
	FCE000001430	14	30	5000-6500	250-800 mm/min
	FCE000001440	14	40		
	FCE000001630	16	30		
	FCE000001640	16	40		
	FCE000001650	16	50		
	FCE000002030	20	30		
	FCE000002040	20	40		
	FCE000002050	20	50		
	FCE000002060	20	60		
	FCE000002080	20	80		
FCE0000020100	20	100			

F-12

FRESE ELETTRODEPOSTE  
ELECTROPLATED ROUTERS

# — Frese Foretti *Routers and Drills* —



GR MR

## TESTINA INTERCAMBIABILE ELETTRODEPOSTA

### ELECTROPLATED CHANGEABLE HEADS

	COD	Ø	H	r	CONN	RPM	FEED
TI	TI0001620M10	16	20	8	M10	5000-6500	350-800 mm/min
	TIR001620M10	16	20		M12		
	TI0002020M12	20	20		M14		
	TI0002020M14	20	20	10	M12		
	TIR002020M12	20	20		M14		
	TIR002020M14	20	20		M14		
	TI0002520M14	25	20	12,5	M14		
	TIR002520M14	25	20		½ GAS		
	TI0003030M14	30	30				
	TIR003030M14	30	30	15			
	TI0003230M14	32	30		M14		
	TI0003230MG	32	30		½ GAS		



GR MR

## FRESA CILINDRICA ELETTRODEPOSTA PER TESTINE

### ELECTROPLATED CYLINDRICAL BIT FOR CHANGEABLE HEADS

	COD	Ø	H	CONN	RPM	FEED
FFT	FFT001630M10	16	30	M10	DA VALUTARE TO BE ASSESSED	DA VALUTARE TO BE ASSESSED
	FFT001650M10	16	50	M10		
	FFT001680M10	16	80	M10		
	FFT002030M12	20	30	M12		
	FFT002030M14			M14		
	FFT002050M12	20	50	M12		
	FFT002050M14			M14		
	FFT002080M12	20	80	M12		
	FFT002080M14			M14		
	FFT020100M12	20	100	M12		
	FFT020100M14			M14		
	FFT002550M14	25	50	M14		
	FFT025100M14	25	100	M14		
	FFT030100M14	30	100	M14		
	FFT0030100MG			½ GAS		
	FFT030150M14	30	150	M14		
	FFT0030150MG			½ GAS		
	FFT032100M14	32	100	M14		
	FFT0032100MG			½ GAS		
	FFT032150M14	32	150	M14		
	FFT0032150MG			½ GAS		



# — Frese Foretti *Routers and Drills* —



GR

## FRESA CILINDRICA ELETTRODEPOSTA PER TESTINE ATTACCO FLANGIA

### ELECTROPLATED CYLINDRICAL BIT FOR CHANGEABLE HEADS FLANGE CONNECTION

	COD	Ø	H	CONN	RPM	FEED	
FFTF	FFTF20150M12	20	150	M12	DA VALUTARE TO BE ASSESSED	DA VALUTARE TO BE ASSESSED	
	FFTF20150M14			M14			
	FFTF20200M12	20	200	M12			
	FFTF20200M14			M14			
	FFTF25150M14	25	150	M14			
	FFTF25200M14	25	200	M14			
	FFTF30150M14	30	150	M14			
	FFTF030150MG			½ GAS			
	FFTF30200M14	30	200	M14			
	FFTF030200MG			½ GAS			
	FFTF32150M14	32	150	M14			
	FFTF032150MG			½ GAS			
	FFTF32200M14	32	200	M14			
	FFTF032200MG			½ GAS			



MR

## FRESA PER LAVELLI ATTACCO ½ GAS

### ELECTROPLATED SINK BIT ½ GAS CONNECTION

	COD	Ø	H	r	L	RPM	FEED	
FLE	FLE005040R20	50	40	20	100	4500-6000	500-800 mm/min	
	FLE006040R20	60	40	20	100			
	FLE008540R20	85	40	20	100			

## FRESA PER LAVELLI ATTACCO FLANGIA

### ELECTROPLATED SINK BIT FLANGE CONNECTION

	COD	Ø	H	r	L	RPM	FEED	
FLEF	FLEF05040R20	50	40	20	100	4500-6000	500-800 mm/min	
	FLEF06040R20	60	40	20	100			
	FLEF08540R20	85	40	20	100			

F-14

FRESE ELETTRODEPOSTE  
ELECTROPLATED ROUTERS

# — Frese Foretti *Routers and Drills* —



MR

## FORETTO ELETTRODEPOSTO ATTACCO ½ GAS

### ELECTROPLATED DRILL WITH ½ GAS CONNECTION

	COD	Ø	H utile	RPM	FEED
FDE	FDE000020100	20	100	1400-3000	40-150 mm/min
	FDE000025100	25	100		
	FDE000030100	30	100		
	FDE000035100	35	100		
	FDE000040100	40	100		
	FDE000050100	50	100		
	FDE000060100	60	100		
	FDE000080100	80	100		
	FDE000100100	100	100		
	FDE000120100	120	100		
	FDE000150100	150	100		



MR

## TESTINA FORETTO INTERCambiabile

### ELECTROPLATED CHANGEABLE HEAD FOR DRILL

	COD	Ø	H utile	RPM	FEED
RFE	RFE000005050	50	50	DA VALUTARE TO BE ASSESSED	DA VALUTARE TO BE ASSESSED
	RFE000008050	80	50		
	RFE000010050	100	50		

F-15

**FRESE ELETTRODEPOSTE**  
ELECTROPLATED ROUTERS



# — Frese Foretti *Routers and Drills* —



GR

## FRESA AL POLICRISTALLINO ATTACCO 1/2 GAS

### PCD BIT WITH 1/2 GAS CONNECTION

	COD	Ø	r	H	H utile	RPM	FEED
FPCD	FPCD05251555	5	2,5	15	55	4500-7000	80-100 mm/min prof. pass. 3 mm
	FPCD00841555	8	4	15	55		

## FRESA AL POLICRISTALLINO ATTACCO CILINDRICO

### PCD BIT WITH CYLINDRICAL CONNECTION

	COD	α°	Ø ATTACCO	RPM	FEED
FPOL	FPOL00003010	30	10	7000-8000	150-250 mm/min Asportaz. 0-3 mm
	FPOL00006010	60	10		
	FPOL00009010	90	10		
	FPOL00010510	105	10		
	FPOL00012010	120	10		



MR

## FRESA AL WIDIAM ATTACCO 1/2 GAS

### WIDIAM BIT WITH 1/2 GAS CONNECTION

	COD	Ø	r	H	RPM	FEED
FW	FW0000031530	3	1,5	30	5500-7000	100-300 mm/min prof. pass. 2 mm
	FW0000052530	5	2,5	30		
	FW0000031550	3	1,5	50		
	FW0000052550	5	2,5	50		

## FRESA AL WIDIAM ATTACCO CILINDRICO

### WIDIAM BIT WITH CYLINDRICAL CONNECTION

	COD	α°	Ø ATTACCO	RPM	FEED
FPOL	FPOL00003010	30	10	3000-5000	100-200 mm/min 2-3 mm
	FPOL00006010	60	10		
	FPOL00009010	90	10		

F-16

FRESE ELETTRODEPSTE  
ELECTROPLATED ROUTERS



— **Frese Foretti** *Routers and Drills* —



**F-17**



**FRESE ELETTRODEPOSTE**  
*ELECTROPLATED ROUTERS*

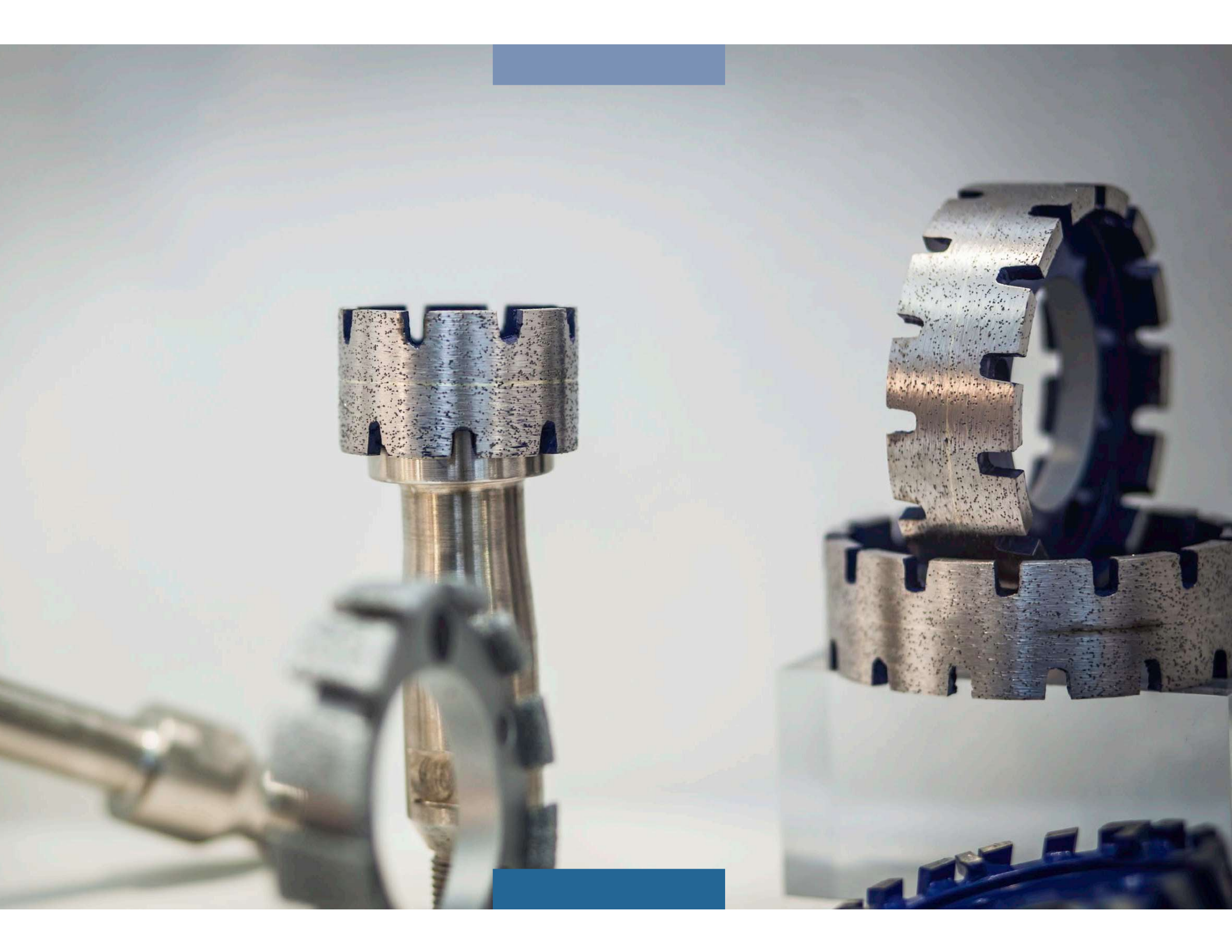



# Mole *Diamond Wheels*

Mole per la calibratura e la sagomatura di marmo, granito, materiali ceramici, pietre naturali ed agglomerati.

*Wheels for the calibration and shaping of marble, granite, ceramic materials, natural stone and composite materials.*

# Mole *Diamond wheels*

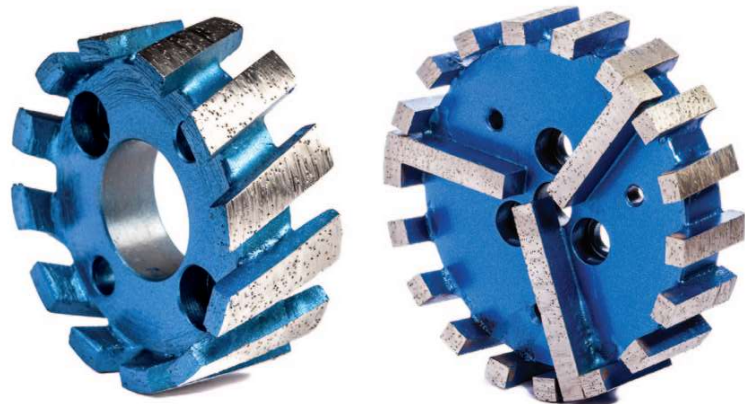

GR

## MOLA DA SBANCO A SETTORI PER GRANITO

### SEGMENTED REVERSIBLE STUBBING WHEEL FOR GRANITE

	COD	Ø	H	FORATURA	RPM	FEED		
MSG	MSG050202H10	50	20	2+2 HOLES BORE Ø10	5000-5500	350-500 mm/min		
	MSG050202H20	50	20	2+2 HOLES BORE Ø20				
	MSG050203H10	50	20	3+3 HOLES BORE Ø10				
	MSG050203H14	50	20	3+3 HOLES BORE Ø14				
	MSG050302H10	50	30	2+2 HOLES BORE Ø10				
	MSG050302H20	50	30	2+2 HOLES BORE Ø20				
	MSG050303H10	50	30	3+3 HOLES BORE Ø10				
	MSG050303H14	50	30	3+3 HOLES BORE Ø14				
	MSG085203H50	85	20	3+3 HOLES BORE Ø50			3800-4500	350-500 mm/min
	MSG085303H50	85	30	3+3 HOLES BORE Ø50				

## MOLA DA SBANCO A SETTORI PER GRANITO RINFORZATA NON REVERSIBILE

### SEGMENTED REINFORCED NOT REVERSIBLE STUBBING WHEEL FOR GRANITE

	COD	Ø	H	FORATURA	RPM	FEED
MSGNR	MSGNR53252H10	53	25	2 HOLES BORE Ø10	5000-5500	350-500 mm/min
	MSGNR85206H50	85	25	6 HOLES BORE Ø50	3800-4500	

GR

## MOLA DA SBANCO GRECATA PER GRANITO

### GRECATA REVERSIBLE STUBBING WHEEL FOR GRANITE

	COD	Ø	H	FORATURA	RPM	FEED		
MSGR	MSGR50302H10	50	30	2+2 HOLES BORE Ø10	5000-5500	400-600 mm/min		
	MSGR50302H20	50	30	2+2 HOLES BORE Ø20				
	MSGR50303H10	50	30	3+3 HOLES BORE Ø10				
	MSGR50303H14	50	30	3+3 HOLES BORE Ø14				
	MSGR60302H10	60	30	2+2 HOLES BORE Ø10				
	MSGR60302H20	60	30	2+2 HOLES BORE Ø20				
	MSGR60303H10	60	30	3+3 HOLES BORE Ø10				
	MSGR60303H14	60	30	3+3 HOLES BORE Ø14				
	MSGR85303H50	85	30	3+3 HOLES BORE Ø50			3800-4500	400-600 min/min
	MSGR90303H50	90	30	3+3 HOLES BORE Ø50				
	MSGR125303H50	125	30	3+3 HOLES BORE Ø50				
	MSGR150303H50	150	30	3+3 HOLES BORE Ø50			3500-4200	400-600 mm/min

M-2

MOLE SINTERIZZATE  
SINTERED DIAMOND WHEELS

# Mole *Diamond wheels*

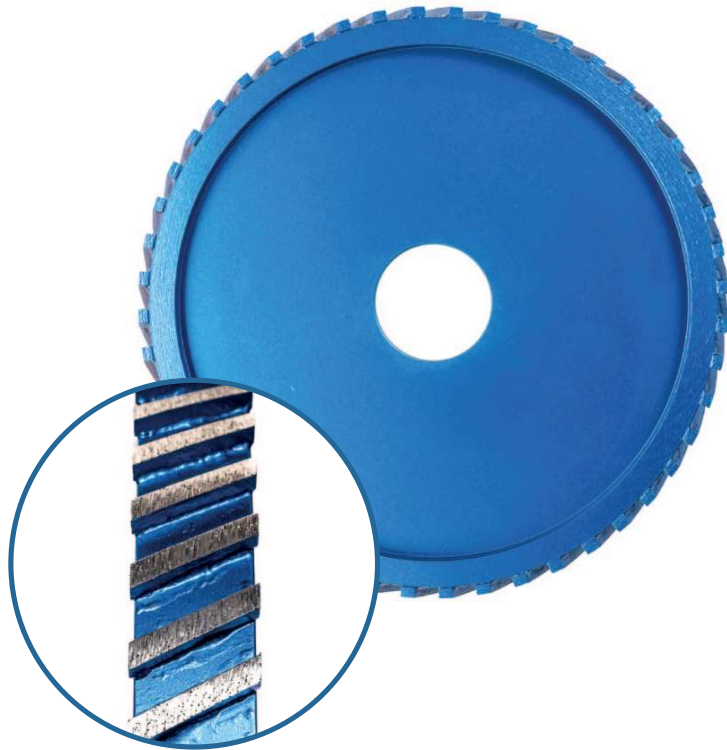

GR

MOLA PIANA A SETTORI PER GRANITO

SEGMENTED FLAT WHEEL FOR GRANITE

	COD	Ø	SP		
MG	MG0000020010	200	10		
	MG0000020020	200	20		
	MG0000020030	200	30		
	MG0000020040	200	40		
	MG0000025010	250	10		
	MG0000025020	250	20		
	MG0000025030	250	30		
	MG0000025040	250	40		
	MG0000030010	300	10		
	MG0000030020	300	20		
	MG0000030030	300	30		
	MG0000030040	300	40		
	MG0000030060	300	60		
	MG0000035010	350	10		
	MG0000035020	350	20		
	MG0000035030	350	30		
	MG0000035040	350	40		
	MG0000035060	350	60		
	MG0000040010	400	10		
	MG0000040020	400	20		
MG0000040030	400	30			
MG0000040040	400	40			
MG0000040050	400	50			
MG0000040060	400	60			

M-3

MOLE SINTERIZZATE  
SINTERED DIAMOND WHEELS



# Mole *Diamond wheels*

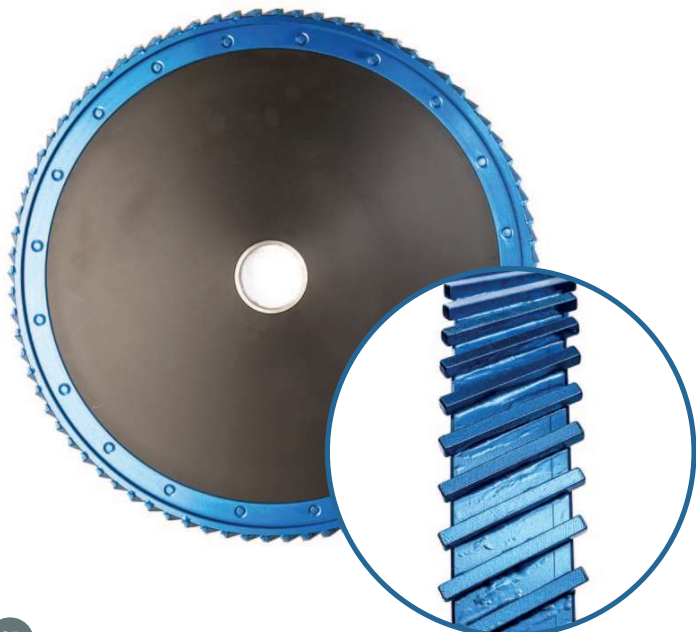

GR

**MOLA PIANA A SETTORI PER GRANITO CON CORPO IN PVC**  
**SEGMENTED FLAT WHEEL FOR GRANITE WITH PVC BODY**

	COD	Ø	H	€
MGPVC	MGPVC0035030	350	30	
	MGPVC0035040	350	40	
	MGPVC0035050	350	50	
	MGPVC0040030	400	30	
	MGPVC0040040	400	40	
	MGPVC0040050	400	50	
	MGPVC0050030	500	30	
	MGPVC0050040	500	40	
	MGPVC0050050	500	50	



GR

**ANELLO PER MOLA PIANA A SETTORI IN PVC PER GRANITO**  
**SEGMENTED RING FOR FLAT WHEEL PVC BODY FOR GRANITE**

	COD	Ø	H	€
AMGPVC	AMGPVC035030	350	30	
	AMGPVC035040	350	40	
	AMGPVC035050	350	50	
	AMGPVC040030	400	30	
	AMGPVC040040	400	40	
	AMGPVC040050	400	50	
	AMGPVC050030	500	30	
	AMGPVC050040	500	40	
	AMGPVC050050	500	50	

M-4

**MOLE SINTERIZZATE**  
**SINTERED DIAMOND WHEELS**

# Mole *Diamond wheels*



MR

MOLA PIANA A SETTORI PER MARMO

SEGMENTED FLAT WHEEL FOR MARBLE

	COD	Ø	SP		
MM	MM0000020010	200	10		
	MM0000020020	200	20		
	MM0000020030	200	30		
	MM0000020040	200	40		
	MM0000025010	250	10		
	MM0000025020	250	20		
	MM0000025030	250	30		
	MM0000025040	250	40		
	MM0000030010	300	10		
	MM0000030020	300	20		
	MM0000030030	300	30		
	MM0000030040	300	40		
	MM0000030060	300	60		
	MM0000035010	350	10		
	MM0000035020	350	20		
	MM0000035030	350	30		
	MM0000035040	350	40		
	MM0000035060	350	60		
	MM0000040010	400	10		
	MM0000040020	400	20		
MM0000040030	400	30			
MM0000040040	400	40			
MM0000040050	400	50			
MM0000040060	400	60			

M-5

MOLE SINTERIZZATE  
SINTERED DIAMOND WHEELS

# Mole *Diamond wheels*

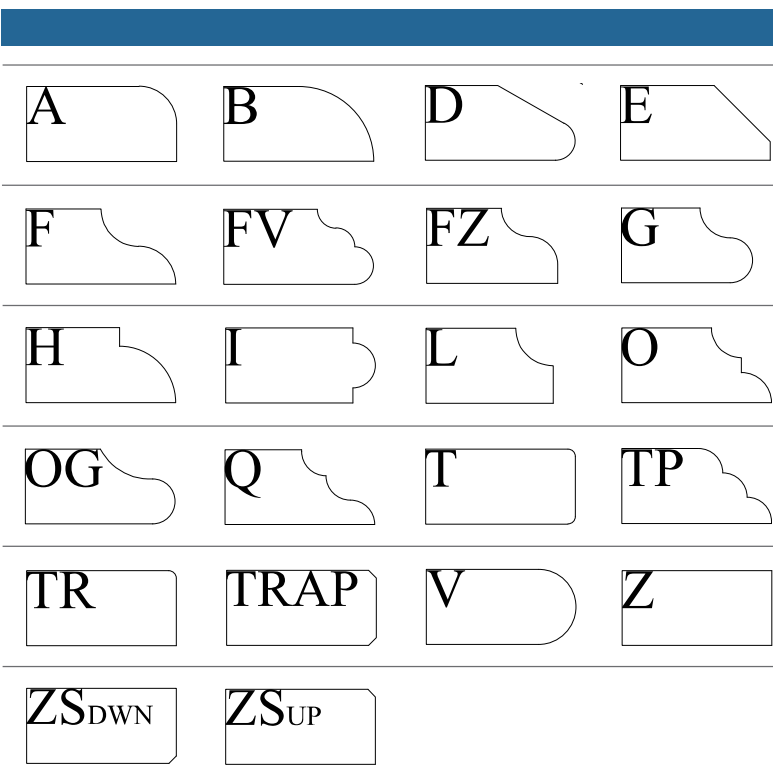

GR

## MOLA A PROFILO SETTORI PER GRANITO

### SEGMENTED PROFILING WHEEL FOR GRANITE

	COD	Ø	SP		
MPG	MPG000015010	150	10		
	MPG000015020	150	20		
	MPG000015030	150	30		
	MPG000015040	150	40		
	MPG000020010	200	10		
	MPG000020020	200	20		
	MPG000020030	200	30		
	MPG000020040	200	40		
	MPG000020060	200	60		
	MPG000025010	250	10		
	MPG000025020	250	20		
	MPG000025030	250	30		
	MPG000025040	250	40		
	MPG000025060	250	60		
	MPG000030010	300	10		
	MPG000030020	300	20		
	MPG000030030	300	30		
	MPG000030040	300	40		
	MPG000030060	300	60		
	MPG000035010	350	10		
	MPG000035020	350	20		
	MPG000035030	350	30		
	MPG000035040	350	40		
	MPG000035060	350	60		
	MPG000040010	400	10		
	MPG000040020	400	20		
	MPG000040030	400	30		
	MPG000040040	400	40		
	MPG000040050	400	50		
	MPG000040060	400	60		

M-6

MOLE SINTERIZZATE  
SINTERED DIAMOND WHEELS



# Mole *Diamond wheels*

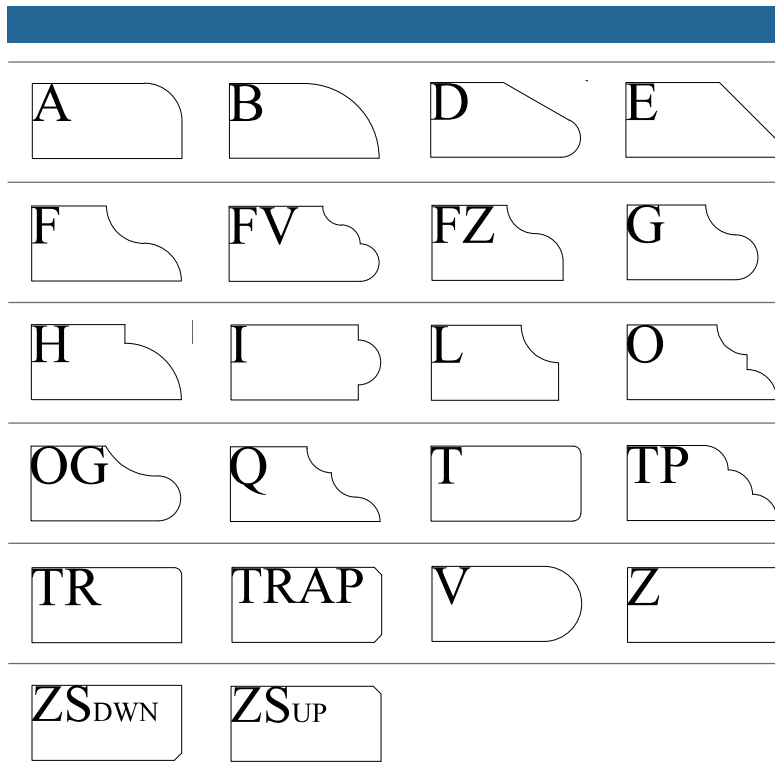

MR

## MOLA A PROFILO SETTORI PER MARMO

### SEGMENTED PROFILING WHEEL FOR MARBLE

	COD	Ø	SP		
MPM	MPM000015010	150	10		
	MPM000015020	150	20		
	MPM000015030	150	30		
	MPM000015040	150	40		
	MPM000020010	200	10		
	MPM000020020	200	20		
	MPM000020030	200	30		
	MPM000020040	200	40		
	MPM000020060	200	60		
	MPM000025010	250	10		
	MPM000025020	250	20		
	MPM000025030	250	30		
	MPM000025040	250	40		
	MPM000025060	250	60		
	MPM000030010	300	10		
	MPM000030020	300	20		
	MPM000030030	300	30		
	MPM000030040	300	40		
	MPM000030060	300	60		
	MPM000035010	350	10		
	MPM000035020	350	20		
	MPM000035030	350	30		
	MPM000035040	350	40		
	MPM000035060	350	60		
	MPM000040010	400	10		
	MPM000040020	400	20		
	MPM000040030	400	30		
	MPM000040040	400	40		
	MPM000040050	400	50		
	MPM000040060	400	60		

M-7

MOLE SINTERIZZATE  
SINTERED DIAMOND WHEELS

# Mole *Diamond wheels*



GR

MOLA DA TORNIO A SETTORI PER GRANITO

SEGMENTED LATHE WHEEL FOR GRANITE

	COD	Ø	H SETTORE	SP
MTG	MTG000004008	400	10	8
	MTG000040010	400		10
	MTG000040012	400		12
	MTG000005008	500		8
	MTG000050010	500		10
	MTG000050012	500		12
	MTG000006008	600		8
	MTG000060010	600		10
	MTG000060012	600		12



MR

MOLA DA TORNIO A SETTORI PER MARMO

SEGMENTED LATHE WHEEL FOR MARBLE

	COD	Ø	H SETTORE	SP
MTM	MTM000004008	400	10	8
	MTM000040010	400		10
	MTM000040012	400		12
	MTM000005008	500		8
	MTM000050010	500		10
	MTM000050012	500		12
	MTM000006008	600		8
	MTM000060010	600		10
	MTM000060012	600		12

M-8

MOLE SINTERIZZATE  
SINTERED DIAMOND WHEELS

# Mole *Diamond wheels*



GR MR

**MOLA PER LUCIDACOSTE PRE-TAGLIO A SETTORI**

**SEGMENTED PER-CUT WHEEL FOR EDGE POLISHING MACHINE**

	COD	Ø	ATTACCO
MLPT	MLPT00000100	100	CHIOCCIOLA
	MLPT00000130	130	CHIOCCIOLA
	MLPT00000150	150	CHIOCCIOLA



GR MR

**MOLA PER LUCIDACOSTE A CORONA CONTINUA**

**CONTINUOUS RIM WHEEL FOR EDGE POLISHING MACHINE**

	COD	Ø	ATTACCO
MLSC	MLSC00000100	100	CHIOCCIOLA
	MLSC00000130	130	CHIOCCIOLA
	MLSC00000150	150	CHIOCCIOLA

**M-9**

**MOLE SINTERIZZATE**  
SINTERED DIAMOND WHEELS



# Mole *Diamond wheels*



MR

## MOLA DA SBANCO ELETTRODEPOSTA

### ELECTROPLATED REVERSIBLE STUBBING WHEEL

	COD	Ø	H	FORATURA	RPM	FEED
MSM	MSM050202H10	50	20	2+2 HOLES BORE Ø10	5500-7000	1000-1500 mm/min Z max -3mm
	MSM050202H20	50	20	2+2 HOLES BORE Ø20		
	MSM050203H10	50	20	3+3 HOLES BORE Ø10		
	MSM050203H14	50	20	3+3 HOLES BORE Ø14		
	MSM050302H10	50	30	2+2 HOLES BORE Ø10		
	MSM050302H20	50	30	2+2 HOLES BORE Ø20		
	MSM050303H10	50	30	3+3 HOLES BORE Ø10		
	MSM050303H14	50	30	3+3 HOLES BORE Ø14		
	MSM085203H50	85	20	3+3 HOLES BORE Ø50	4000-5200	
	MSM085303H50	85	30	3+3 HOLES BORE Ø50		



MR

## MOLA DA SBANCO ELETTRODEPOSTA TIPO MAGNUM

### ELECTROPLATED REVERSIBLE STUBBING WHEEL MAGNUM TYPE

	COD	Ø	H	FORATURA	RPM	FEED
MSMG	MSMGMS0202H10	50	20	2 HOLES BORE Ø10	5500-7000	1000-1500 mm/min
	MSMGM85206H50	85	20	6 HOLES BORE Ø50	4000-5200	Z max -3mm

M-10

MOLE ELETTRODEPOSTE  
ELECTROPLATED DIAMOND WHEELS

# Mole *Diamond wheels*

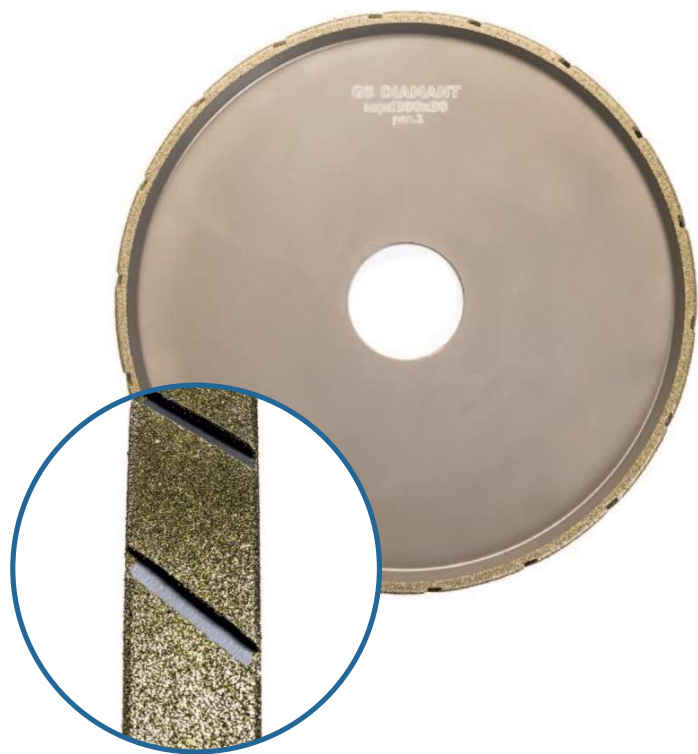

MR

MOLA PIANA ELETTRODEPOSTA			
ELECTROPLATED FLAT WHEEL			
	COD	Ø	SP
MME	MME000015010	150	10
	MME000015020	150	20
	MME000015030	150	30
	MME000020010	200	10
	MME000020020	200	20
	MME000020030	200	30
	MME000020040	200	40
	MME000025010	250	10
	MME000025020	250	20
	MME000025030	250	30
	MME000025040	250	40
	MME000025050	250	50
	MME000025060	250	60
	MME000030010	300	10
	MME000030020	300	20
	MME000030030	300	30
	MME000030040	300	40
	MME000030050	300	50
	MME000030060	300	60
	MME000035010	350	10
	MME000035020	350	20
	MME000035030	350	30
	MME000035040	350	40
	MME000035050	350	50
	MME000035060	350	60
	MME000040010	400	10
	MME000040020	400	20
	MME000040030	400	30
	MME000040040	400	40
	MME000040050	400	50
	MME000040060	400	60

M-11

MOLE ELETTRODEPOSTE  
ELECTROPLATED DIAMOND WHEELS

# Mole *Diamond wheels*

MR

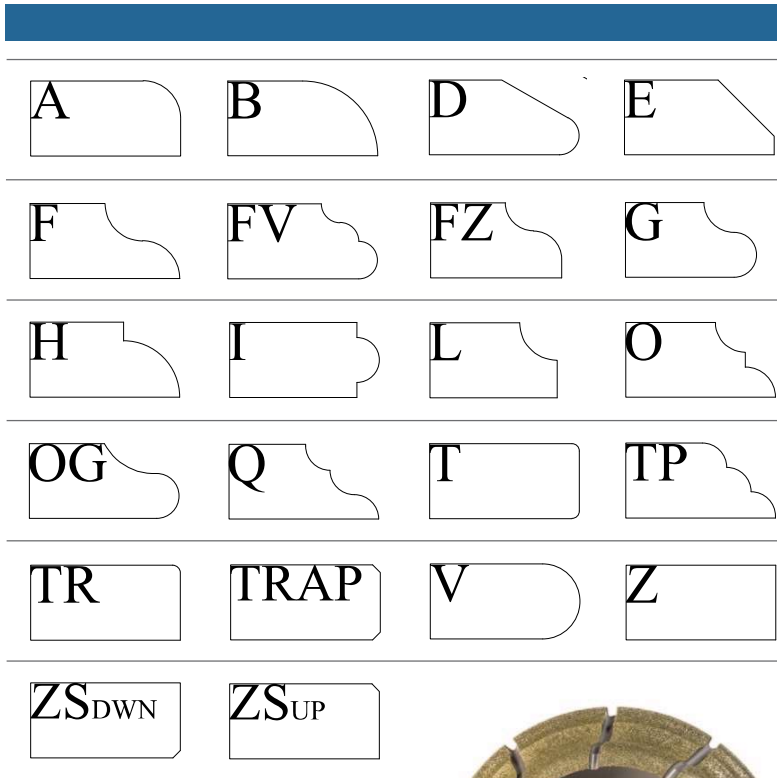

M-12

MOLE ELETTRORODEPSTE  
ELECTROPLATED DIAMOND WHEELS

MOLA A PROFILO ELETTRORODEPSTA			
ELECTROPLATED PROFILING WHEEL			
	COD	Ø	SP
MPE	MPE000015010	150	10
	MPE000015020	150	20
	MPE000015030	150	30
	MPE000015040	150	40
	MPE000015050	150	50
	MPE000015060	150	60
	MPE000020010	200	10
	MPE000020020	200	20
	MPE000020030	200	30
	MPE000020040	200	40
	MPE000020050	200	50
	MPE000020060	200	60
	MPE000025010	250	10
	MPE000025020	250	20
	MPE000025030	250	30
	MPE000025040	250	40
	MPE000025050	250	50
	MPE000025060	250	60
	MPE000030010	300	10
	MPE000030020	300	20
	MPE000030030	300	30
	MPE000030040	300	40
	MPE000030050	300	50
	MPE000030060	300	60
	MPE000035010	350	10
	MPE000035020	350	20
	MPE000035030	350	30
	MPE000035040	350	40
	MPE000035050	350	50
	MPE000035060	350	60

# Mole *Diamond wheels*

Segue / follows

MOLA A PROFILO ELETTRORDEPOSTA			
ELECTROPLATED PROFILING WHEEL			
COD	Ø	SP	
MPE000040010	400	10	
MPE000040020	400	20	
MPE000040030	400	30	
MPE000040040	400	40	
MPE000040050	400	50	
MPE000040060	400	60	
MPE000040080	400	80	



MR

MOLA DA TORNIO ELETTRORDEPOSTA			
ELECTROPLATED WHEEL FOR LATHE			
	COD	Ø	SP
MTE	MTE035081010	350	8X10X10
	MTE350101010	350	10X10X10
	MTE350121010	350	12X10X10
	MTE040081010	400	8X10X10
	MTE400101010	400	10X10X10
	MTE400121010	400	12X10X10
	MTE050081010	500	8X10X10
	MTE500101010	500	10X10X10
	MTE500121010	500	12X10X10
	MTE060081010	600	8X10X10
	MTE600101010	600	10X10X10
	MTE600121010	600	12X10X10

M-13

MOLE ELETTRORDEPOSTE  
ELECTROPLATED DIAMOND WHEELS





# Dischi *Blades*

Dischi a settori ed elettrolitici per marmo, granito, materiali ceramici e agglomerati, sia per macchine manuali che per macchine a controllo numerico.

*Segmented and electrolytic blades for marble, granite, ceramic and composite materials, both for hand and numerical control machines.*

# Dischi *Blades*



MR

DISCO A SETTORI PER MARMO ANIMA SILENZIATA

SEGMENTED BLADE FOR MARBLE SILENT CORE

	LEGANTE	TIPO SETTORE	CODICE	Ø	H	
DMS	T 16	DS	DMS0300T16DS	300	7	
			DMS0350T16DS	350	7	
			DMS0400T16DS	400	7	
			DMS0500T16DS	500	7	
			DMS0625T16DS	625	7	



MR

DISCO A SETTORI PER MARMO ANIMA NORMALE

SEGMENTED BLADE FOR MARBLE NORMAL CORE

	LEGANTE	TIPO SETTORE	CODICE	Ø	H	
DMN	T 16	DS	DMN0300T16DS	300	7	
			DMN0350T16DS	350	7	
			DMN0400T16DS	400	7	
			DMN0500T16DS	500	7	
			DMN0625T16DS	625	7	

D-2

DISCHI SINTERIZZATI  
SINTERED BLADES

# Dischi *Blades*



GR

DISCO A SETTORI PER GRANITO ANIMA SILENZIATA

SEGMENTED BLADE FOR GRANITE SILENT CORE

	LEGANTE	TIPO SETTORE	CODICE	Ø	H	
DGS	T 130	COMBI	DGS0300T130C	300	12	
			DGS0350T130C	350		
			DGS0400T130C	400		
			DGS0500T130C	500		
			DGS0625T130C	625		
		DS	DGS300T130DS	300	12	
			DGS350T130DS	350		
			DGS400T130DS	400		
			DGS500T130DS	500		
			DGS625T130DS	625		
	T 150	COMBI	DGS0300T150C	300	12	
			DGS0350T150C	350		
			DGS0400T150C	400		
			DGS0500T150C	500		
			DGS0625T150C	625		
		DS	DGS300T150DS	300	12	
			DGS350T150DS	350		
			DGS400T150DS	400		
			DGS500T150DS	500		
			DGS625T150DS	625		



GR

DISCO A SETTORI PER GRANITO ANIMA NORMALE

SEGMENTED BLADE FOR GRANITE NORMAL CORE

	LEGANTE	TIPO SETTORE	CODICE	Ø	H	
DG	T 130	COMBI	DGN0300T130C	300	12	
			DGN0350T130C	350		
			DGN0400T130C	400		
			DGN0500T130C	500		
			DGN0625T130C	625		
		DS	DGN300T130DS	300	12	
			DGN350T130DS	350		
			DGN400T130DS	400		
			DGN500T130DS	500		
			DGN625T130DS	625		
	T 150	COMBI	DGN0300T150C	300	12	
			DGN0350T150C	350		
			DGN0400T150C	400		
			DGN0500T150C	500		
			DGN0625T150C	625		
		DS	DGN300T150DS	300	12	
			DGN350T150DS	350		
			DGN400T150DS	400		
			DGN500T150DS	500		
			DGN625T150DS	625		

D-3

DISCHI SINTERIZZATI  
SINTERED BLADES



# Dischi *Blades*

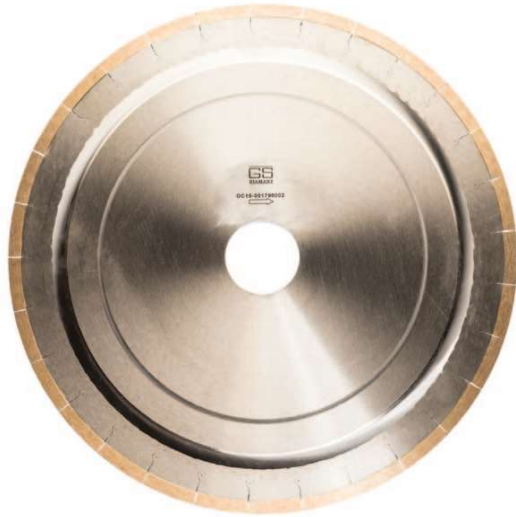

TM

DISCO A SETTORI PER MATERIALI TECNICI ANIMA NORMALE

SEGMENTED BLADE FOR TECHNICAL MATERIALS NORMAL CORE

	LEGANTE	TIPO SETTORE	CODICE	Ø	H	N° SETTORI	
DYN	Y	DS	DYN0350YD1DS	350	10	25	
			DYN400YD1DSA	400	10	29	
			DYN400YD1DSB	400	10	29	



K

DISCO A SETTORI PER CERAMICA ANIMA NORMALE

SEGMENTED BLADE FOR CERAMIC NORMAL CORE

	LEGANTE	TIPO SETTORE	CODICE	Ø	H	N° SETTORI	
DYN	K	DS	DKN0350KP1DS	350	10	2	
			DKN0400KP1DS	400	10	29	

D-4

DISCHI SINTERIZZATI  
SINTERED BLADES



**Dischi** *Blades*



**D-5**



# Dischi *Blades*

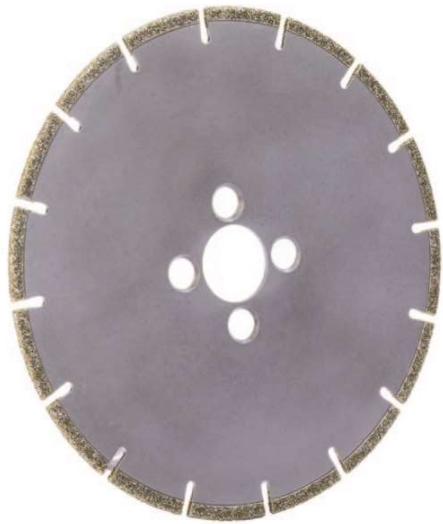

MR

DISCO DA TAGLIO ELETTRODEPOSTO

ELECTROPLATED BLADE FOR MANUAL MACHINE

	COD	Ø		
DFT	DFT0000001	1		
	DFT000000125	125		
	DFT000000150	150		
	DFT000000180	180		
	DFT000000230	230		



MR

DISCO DA TAGLIO ELETTRODEPOSTO CON RINFORZI

ELECTROPLATED BLADE FOR MANUAL MACHINE WITH RENFORCE

	COD	Ø		
DFTR	DFTR0000001	1		
	DFTR000000125	125		
	DFTR000000150	150		
	DFTR000000180	180		
	DFTR000000230	230		

D-6

DISCHI ELETTRODEPOSTI  
ELECTROPLATED BLADES

# Dischi *Blades*



MR

DISCO DA TAGLIO ELETTRORDEPOSTO VENTILATO

ELECTROPLATED AIRY BLADE FOR MANUAL MACHINE

	COD	Ø		
DFT	DFTVNT000125	125		
	DFTVNT000150	150		



MR

DISCO ELETTRORDEPOSTO TIPO VIAREGGIO

ELECTROPLATED BLADE VIAREGGIO TYPE

	COD	Ø		
DFTV	DFTV00000125	125		
	DFTV00000150	150		

D-7

DISCHI ELETTRORDEPOSTI  
ELECTROPLATED BLADES



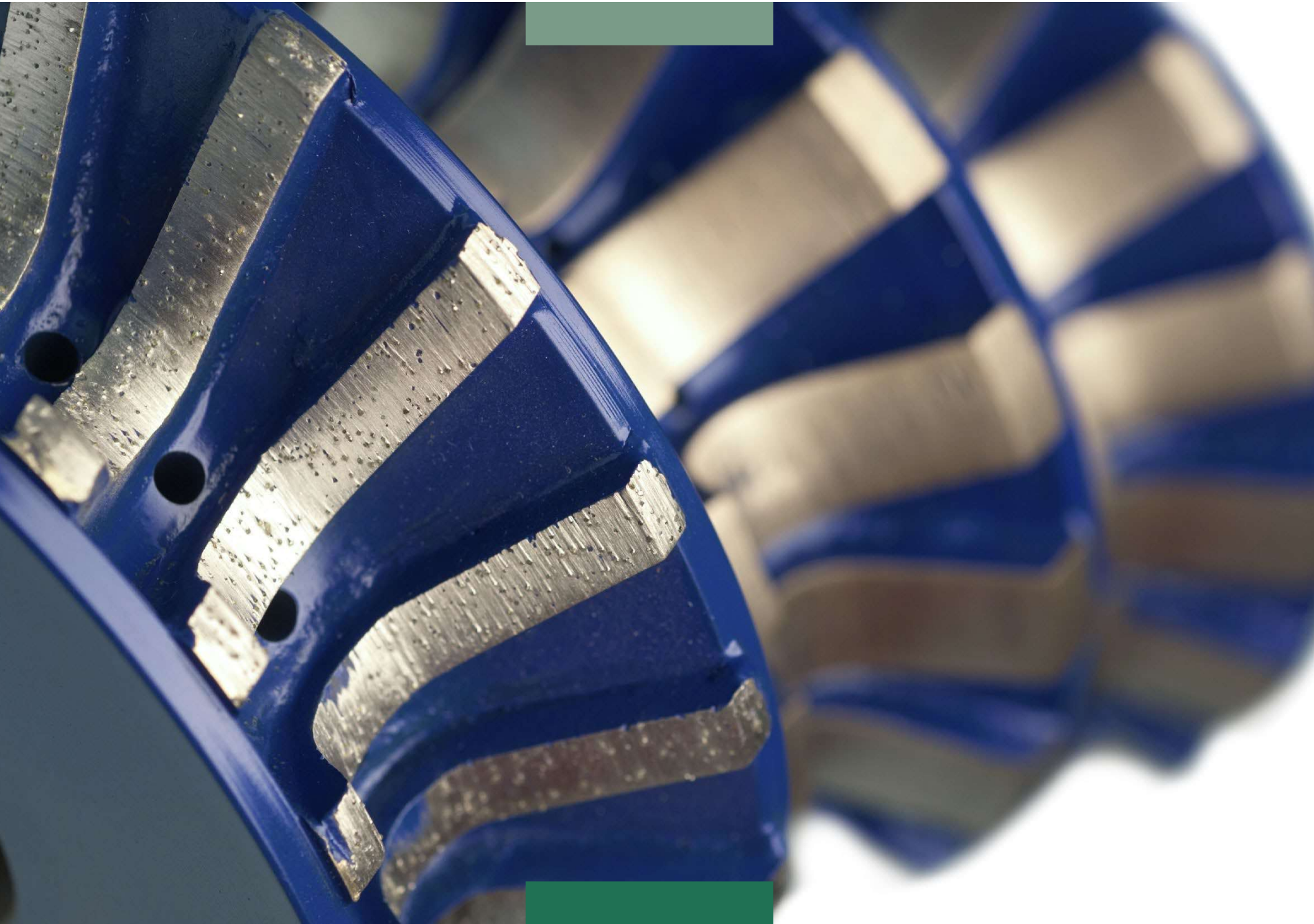

# CNC

Mole e frese per macchine a controllo numerico per marmo, granito e agglomerati.

*Wheels and routers for numerical control machines for marble, granite and composite materials.*

# CNC

A

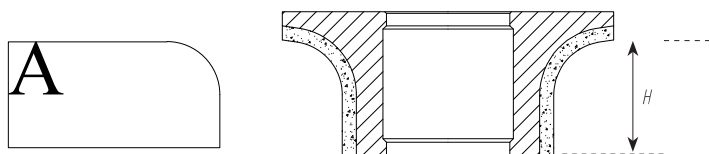

B

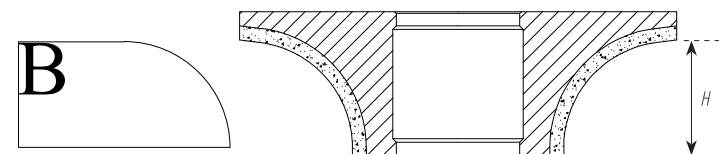

## DIAMANTATO

## ABRASIVO TRADIZIONALE

## HIGH LIFE TECHNOLOGY

### A20

Ø	POS	CODICE	TIPO	Ø	POS	CODICE	ØMIN	POS	CODICE
80	1	CSS0080A20P1	SETTORI	80	5	CA00080A20P5	60	5	CH00060A20P5
80	2	CSC0080A20P2	CORONA CONTINUA	80	6	CA00080A20P6	60	6	CH00060A20P6
80	3	CSC0080A20P3		60	7	CH00060A20P7			
80	4	CSC0080A20P4							

### A30

Ø	POS	CODICE	TIPO	Ø	POS	CODICE	ØMIN	POS	CODICE
80	1	CSS0080A30P1	SETTORI	80	5	CA00080A30P5	60	5	CH00060A30P5
80	2	CSC0080A30P2	CORONA CONTINUA	80	6	CA00080A30P6	60	6	CH00060A30P6
80	3	CSC0080A30P3		60	7	CH00060A30P7			
80	4	CSC0080A30P4							

### A40

Ø	POS	CODICE	TIPO	Ø	POS	CODICE	ØMIN	POS	CODICE
120	1	CSS0120A40P1	SETTORI	120	5	CA00120A40P5	60	5	CH00060A40P5
120	2	CSC0120A40P2	CORONA CONTINUA	120	6	CA00120A40P6	60	6	CH00060A40P6
120	3	CSC0120A40P3		60	7	CH00060A40P7			
120	4	CSC0120A40P4							

## DIAMANTATO

## ABRASIVO TRADIZIONALE

## HIGH LIFE TECHNOLOGY

### B20

Ø	POS	CODICE	TIPO	Ø	POS	CODICE	ØMIN	POS	CODICE
80	1	CSS0080B20P1	SETTORI	80	5	CA00080B20P5	60	5	CH00060B20P5
80	2	CSC0080B20P2	CORONA CONTINUA	80	6	CA00080B20P6	60	6	CH00060B20P6
80	3	CSC0080B20P3		60	7	CH00060B20P7			
80	4	CSC0080B20P4							

### B30

Ø	POS	CODICE	TIPO	Ø	POS	CODICE	ØMIN	POS	CODICE
120	1	CSS0120B30P1	SETTORI	120	5	CA00120B30P5	60	5	CH00060B30P5
120	2	CSC0120B30P2	CORONA CONTINUA	120	6	CA00120B30P6	60	6	CH00060B30P6
120	3	CSC0120B30P3		60	7	CH00060B30P7			
120	4	CSC0120B30P4							

### B40

Ø	POS	CODICE	TIPO	Ø	POS	CODICE	ØMIN	POS	CODICE
140	1	CSS0140B40P1	SETTORI	140	5	CA00140B40P5	60	5	CH00060B40P5
140	2	CSS0140B40P2		60	6	CH00060B40P6			
140	3	CSS0140B40P3		60	7	CH00060B40P7			
140	4	CSS0140B40P4							

C-2

MOLE SINTERIZZATE  
SINTERED DIAMOND WHEELS

# CNC

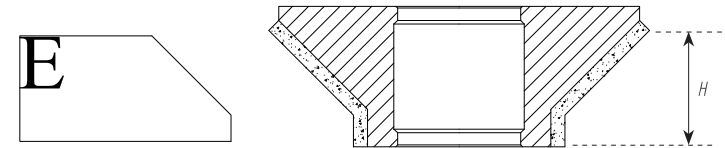
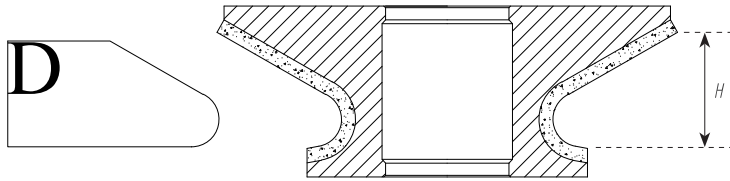

DIAMANTATO				ABRASIVO TRADIZIONALE			HIGH LIFE TECHNOLOGY		
<b>D20</b>									
Ø	POS	CODICE	TIPO	Ø	POS	CODICE	ØMIN	POS	CODICE
120	1	CSS0120D20P1	SETTORI	120	5	CA00120D20P5	60	5	CH00060D20P5
120	2	CSC0120D20P2	CORONA CONTINUA	120	6	CA00120D20P6	60	6	CH00060D20P6
120	3	CSC0120D20P3		60	7	CH00060D20P7			
120	4	CSC0120D20P4							
<b>D30</b>									
Ø	POS	CODICE	TIPO	Ø	POS	CODICE	ØMIN	POS	CODICE
120	1	CSS0120D30P1	SETTORI	120	5	CA00120D30P5	60	5	CH00060D30P5
120	2	CSC0120D30P2	CORONA CONTINUA	120	6	CA00120D30P6	60	6	CH00060D30P6
120	3	CSC0120D30P3		60	7	CH00060D30P7			
120	4	CSC0120D30P4							
<b>D40</b>									
Ø	POS	CODICE	TIPO	Ø	POS	CODICE	ØMIN	POS	CODICE
140	1	CSS0140D40P1	SETTORI	140	5	CA00140D40P5	60	5	CH00060D40P5
140	2	CSS0140D40P2		140	6	CA00140D40P6	60	6	CH00060D40P6
140	3	CSS0140D40P3		60	7	CH00060D40P7			
140	4	CSS0140D40P4							

DIAMANTATO				ABRASIVO TRADIZIONALE			HIGH LIFE TECHNOLOGY		
<b>E20</b>									
Ø	POS	CODICE	TIPO	Ø	POS	CODICE	ØMIN	POS	CODICE
80	1	CSS0080E20P1	SETTORI	80	5	CA00080E20P5	60	5	CH00060E20P5
80	2	CSC0080E20P2	CORONA CONTINUA	80	6	CA00080E20P6	60	6	CH00060E20P6
80	3	CSC0080E20P3		60	7	CH00060E20P7			
80	4	CSC0080E20P4							
<b>E30</b>									
Ø	POS	CODICE	TIPO	Ø	POS	CODICE	ØMIN	POS	CODICE
80	1	CSS0080E30P1	SETTORI	80	5	CA00080E30P5	60	5	CH00060E30P5
80	2	CSC0080E30P2	CORONA CONTINUA	80	6	CA00080E30P6	60	6	CH00060E30P6
80	3	CSC0080E30P3		60	7	CH00060E30P7			
80	4	CSC0080E30P4							
<b>E40</b>									
Ø	POS	CODICE	TIPO	Ø	POS	CODICE	ØMIN	POS	CODICE
80	1	CSS0080E40P1	SETTORI	80	5	CA00080E40P5	60	5	CH00060E40P5
80	2	CSC0080E40P2	CORONA CONTINUA	80	6	CA00080E40P6	60	6	CH00060E40P6
80	3	CSC0080E40P3		60	7	CH00060E40P7			
80	4	CSC0080E40P4							

C-3

MOLE SINTERIZZATE  
SINTERED DIAMOND WHEELS



# CNC

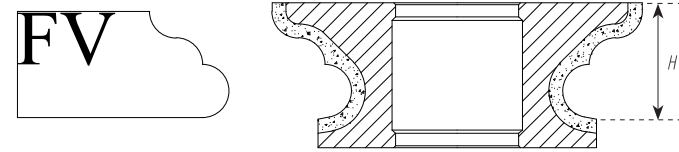
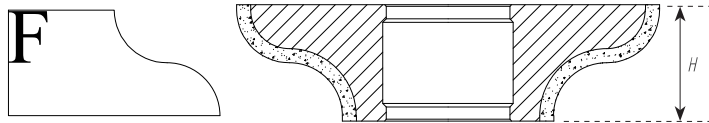

DIAMANTATO				ABRASIVO TRADIZIONALE				HIGH LIFE TECHNOLOGY			
<b>F20</b>											
Ø	POS	CODICE	TIPO	Ø	POS	CODICE		ØMIN	POS	CODICE	
120	1	CSS0120F20P1	SETTORI	120	5	CA00120F20P5		60	5	CH00060F20P5	
120	2	CSC0120F20P2	CORONA CONTINUA	120	6	CA00120F20P6		60	6	CH00060F20P6	
120	3	CSC0120F20P3		60	7	CH00060F20P7					
120	4	CSC0120F20P4									
<b>F30</b>											
Ø	POS	CODICE	TIPO	Ø	POS	CODICE		ØMIN	POS	CODICE	
120	1	CSS0120F30P1	SETTORI	120	5	CA00120F30P5		60	5	CH00060F30P5	
120	2	CSC0120F30P2	CORONA CONTINUA	120	6	CA00120F30P6		60	6	CH00060F30P6	
120	3	CSC0120F30P3		60	7	CH00060F30P7					
120	4	CSC0120F30P4									
<b>F40</b>											
Ø	POS	CODICE	TIPO	Ø	POS	CODICE		ØMIN	POS	CODICE	
140	1	CSS0140F40P1	SETTORI	140	5	CA00140F40P5		60	5	CH00060F40P5	
140	2	CSS0140F40P2		140	6	CA00140F40P6		60	6	CH00060F40P6	
140	3	CSS0140F40P3		60	7	CH00060F40P7					
140	4	CSS0140F40P4									

DIAMANTATO				ABRASIVO TRADIZIONALE				HIGH LIFE TECHNOLOGY			
<b>FV20</b>											
Ø	POS	CODICE	TIPO	Ø	POS	CODICE		ØMIN	POS	CODICE	
120	1	CSS120FV20P1	SETTORI	120	5	CA0120FV20P5		60	5	CH0060FV20P5	
120	2	CSC120FV20P2	CORONA CONTINUA	120	6	CA0120FV20P6		60	6	CH0060FV20P6	
120	3	CSC120FV20P3		60	7	CH0060FV20P7					
120	4	CSC120FV20P4									
<b>FV30</b>											
Ø	POS	CODICE	TIPO	Ø	POS	CODICE		ØMIN	POS	CODICE	
120	1	CSS120FV30P1	SETTORI	120	5	CA0120FV30P5		60	5	CH0060FV30P5	
120	2	CSC120FV30P2	CORONA CONTINUA	120	6	CA0120FV30P6		60	6	CH0060FV30P6	
120	3	CSC120FV30P3		60	7	CH0060FV30P7					
120	4	CSC120FV30P4									
<b>FV40</b>											
Ø	POS	CODICE	TIPO	Ø	POS	CODICE		ØMIN	POS	CODICE	
120	1	CSS120FV40P1	SETTORI	120	5	CA0120FV40P5		60	5	CH0060FV40P5	
120	2	CSC120FV40P2	CORONA CONTINUA	120	6	CA0120FV40P6		60	6	CH0060FV40P6	
120	3	CSC120FV40P3		60	7	CH0060FV40P7					
120	4	CSC120FV40P4									

C-4

MOLE SINTERIZZATE  
SINTERED DIAMOND WHEELS

# CNC

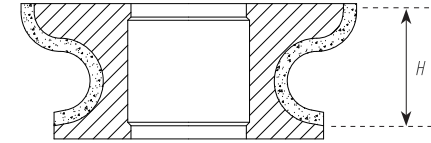
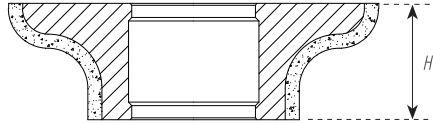

DIAMANTATO				ABRASIVO TRADIZIONALE				HIGH LIFE TECHNOLOGY			
<b>FZ20</b>											
Ø	POS	CODICE	TIPO	Ø	POS	CODICE		ØMIN	POS	CODICE	
120	1	CSS120FZ20P1	SETTORI	120	5	CA0120FZ20P5		60	5	CH0060FZ20P5	
120	2	CSC120FZ20P2	CORONA CONTINUA	120	6	CA0120FZ20P6		60	6	CH0060FZ20P6	
120	3	CSC120FZ20P3		60	7	CH0060FZ20P7					
120	4	CSC120FZ20P4									
<b>FZ30</b>											
Ø	POS	CODICE	TIPO	Ø	POS	CODICE		ØMIN	POS	CODICE	
120	1	CSS120FZ30P1	SETTORI	120	5	CA0120FZ30P5		60	5	CH0060FZ30P5	
120	2	CSC120FZ30P2	CORONA CONTINUA	120	6	CA0120FZ30P6		60	6	CH0060FZ30P6	
120	3	CSC120FZ30P3		60	7	CH0060FZ30P7					
120	4	CSC120FZ30P4									
<b>FZ40</b>											
Ø	POS	CODICE	TIPO	Ø	POS	CODICE		ØMIN	POS	CODICE	
120	1	CSS120FZ40P1	SETTORI	120	5	CA0120FZ40P5		60	5	CH0060FZ40P5	
120	2	CSC120FZ40P2	CORONA CONTINUA	120	6	CA0120FZ40P6		60	6	CH0060FZ40P6	
120	3	CSC120FZ40P3		60	7	CH0060FZ40P7					
120	4	CSC120FZ40P4									

DIAMANTATO				ABRASIVO TRADIZIONALE				HIGH LIFE TECHNOLOGY			
<b>G20</b>											
Ø	POS	CODICE	TIPO	Ø	POS	CODICE		ØMIN	POS	CODICE	
120	1	CSS0120G20P1	SETTORI	120	5	CA00120G20P5		60	5	CH00060G20P5	
120	2	CSC0120G20P2	CORONA CONTINUA	120	6	CA00120G20P6		60	6	CH00060G20P6	
120	3	CSC0120G20P3		60	7	CH00060G20P7					
120	4	CSC0120G20P4									
<b>G30</b>											
Ø	POS	CODICE	TIPO	Ø	POS	CODICE		ØMIN	POS	CODICE	
120	1	CSS0120G30P1	SETTORI	120	5	CA00120G30P5		60	5	CH00060G30P5	
120	2	CSC0120G30P2	CORONA CONTINUA	120	6	CA00120G30P6		60	6	CH00060G30P6	
120	3	CSC0120G30P3		60	7	CH00060G30P7					
120	4	CSC0120G30P4									
<b>G40</b>											
Ø	POS	CODICE	TIPO	Ø	POS	CODICE		ØMIN	POS	CODICE	
120	1	CSS0120G40P1	SETTORI	120	5	CA00120G40P5		60	5	CH00060G40P5	
120	2	CSC0120G40P2	CORONA CONTINUA	120	6	CA00120G40P6		60	6	CH00060G40P6	
120	3	CSC0120G40P3		60	7	CH00060G40P7					
120	4	CSC0120G40P4									

C-5

MOLE SINTERIZZATE  
SINTERED DIAMOND WHEELS

# CNC

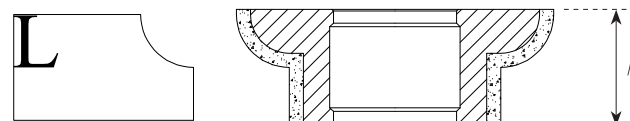
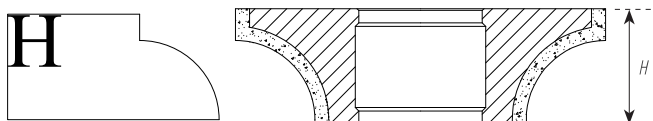

DIAMANTATO				ABRASIVO TRADIZIONALE			HIGH LIFE TECHNOLOGY		
<b>H20</b>									
Ø	POS	CODICE	TIPO	Ø	POS	CODICE	ØMIN	POS	CODICE
120	1	CSS0120H20P1	SETTORI	120	5	CA00120H20P5	60	5	CH00060H20P5
120	2	CSC0120H20P2	CORONA CONTINUA	120	6	CA00120H20P6	60	6	CH00060H20P6
120	3	CSC0120H20P3		60	7	CH00060H20P7			
120	4	CSC0120H20P4							
<b>H30</b>									
Ø	POS	CODICE	TIPO	Ø	POS	CODICE	ØMIN	POS	CODICE
120	1	CSS0120H30P1	SETTORI	120	5	CA00120H30P5	60	5	CH00060H30P5
120	2	CSC0120H30P2	CORONA CONTINUA	120	6	CA00120H30P6	60	6	CH00060H30P6
120	3	CSC0120H30P3		60	7	CH00060H30P7			
120	4	CSC0120H30P4							
<b>H40</b>									
Ø	POS	CODICE	TIPO	Ø	POS	CODICE	ØMIN	POS	CODICE
140	1	CSS0140H40P1	SETTORI	140	5	CA00140H40P5	60	5	CH00060H40P5
140	2	CSS0140H40P2		60	6	CH00060H40P6			
140	3	CSS0140H40P3		60	7	CH00060H40P7			
140	4	CSS0140H40P4							

DIAMANTATO				ABRASIVO TRADIZIONALE			HIGH LIFE TECHNOLOGY		
<b>L20</b>									
Ø	POS	CODICE	TIPO	Ø	POS	CODICE	ØMIN	POS	CODICE
120	1	CSS0120L20P1	SETTORI	120	5	CA00120L20P5	60	5	CH00060L20P5
120	2	CSC0120L20P2	CORONA CONTINUA	120	6	CA00120L20P6	60	6	CH00060L20P6
120	3	CSC0120L20P3		60	7	CH00060L20P7			
120	4	CSC0120L20P4							
<b>L30</b>									
Ø	POS	CODICE	TIPO	Ø	POS	CODICE	ØMIN	POS	CODICE
120	1	CSS0120L30P1	SETTORI	120	5	CA00120L30P5	60	5	CH00060L30P5
120	2	CSC0120L30P2	CORONA CONTINUA	120	6	CA00120L30P6	60	6	CH00060L30P6
120	3	CSC0120L30P3		60	7	CH00060L30P7			
120	4	CSC0120L30P4							
<b>L40</b>									
Ø	POS	CODICE	TIPO	Ø	POS	CODICE	ØMIN	POS	CODICE
140	1	CSS0140L40P1	SETTORI	140	5	CA00140L40P5	60	5	CH00060L40P5
140	2	CSS0140L40P2		60	6	CH00060L40P6			
140	3	CSS0140L40P3		60	7	CH00060L40P7			
140	4	CSS0140L40P4							

C-6

MOLE SINTERIZZATE  
SINTERED DIAMOND WHEELS

# CNC

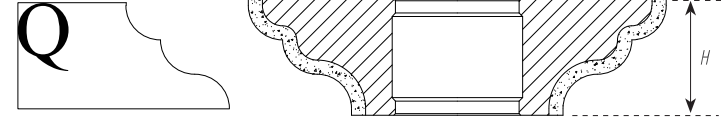
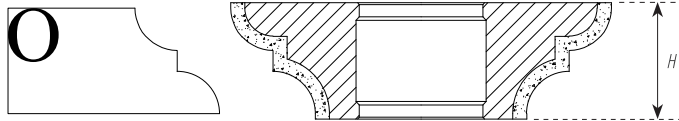

DIAMANTATO				ABRASIVO TRADIZIONALE			HIGH LIFE TECHNOLOGY		
<b>O20</b>									
Ø	POS	CODICE	TIPO	Ø	POS	CODICE	ØMIN	POS	CODICE
120	1	CSS0120O20P1	SETTORI	120	5	CA00120O20P5	60	5	CH00060O20P5
120	2	CSC0120O20P2	CORONA CONTINUA	120	6	CA00120O20P6	60	6	CH00060O20P6
120	3	CSC0120O20P3		60	7	CH00060O20P7			
120	4	CSC0120O20P4							
<b>O30</b>									
Ø	POS	CODICE	TIPO	Ø	POS	CODICE	ØMIN	POS	CODICE
120	1	CSS0120O30P1	SETTORI	120	5	CA00120O30P5	60	5	CH00060O30P5
120	2	CSC0120O30P2	CORONA CONTINUA	120	6	CA00120O30P6	60	6	CH00060O30P6
120	3	CSC0120O30P3		60	7	CH00060O30P7			
120	4	CSC0120O30P4							
<b>O40</b>									
Ø	POS	CODICE	TIPO	Ø	POS	CODICE	ØMIN	POS	CODICE
120	1	CSS0120O40P1	SETTORI	120	5	CA00120O40P5	60	5	CH00060O40P5
120	2	CSC0120O40P2	CORONA CONTINUA	120	6	CA00120O40P6	60	6	CH00060O40P6
120	3	CSC0120O40P3		60	7	CH00060O40P7			
120	4	CSC0120O40P4							

DIAMANTATO				ABRASIVO TRADIZIONALE			HIGH LIFE TECHNOLOGY		
<b>Q20</b>									
Ø	POS	CODICE	TIPO	Ø	POS	CODICE	ØMIN	POS	CODICE
120	1	CSS0120Q20P1	SETTORI	120	5	CA00120Q20P5	60	5	CH00060Q20P5
120	2	CSC0120Q20P2	CORONA CONTINUA	120	6	CA00120Q20P6	60	6	CH00060Q20P6
120	3	CSC0120Q20P3		60	7	CH00060Q20P7			
120	4	CSC0120Q20P4							
<b>Q30</b>									
Ø	POS	CODICE	TIPO	Ø	POS	CODICE	ØMIN	POS	CODICE
120	1	CSS0120Q30P1	SETTORI	120	5	CA00120Q30P5	60	5	CH00060Q30P5
120	2	CSC0120Q30P2	CORONA CONTINUA	120	6	CA00120Q30P6	60	6	CH00060Q30P6
120	3	CSC0120Q30P3		60	7	CH00060Q30P7			
120	4	CSC0120Q30P4							
<b>Q40</b>									
Ø	POS	CODICE	TIPO	Ø	POS	CODICE	ØMIN	POS	CODICE
140	1	CSS0140Q40P1	SETTORI	140	5	CA00140Q40P5	60	5	CH00060Q40P5
140	2	CSS0140Q40P2		140	6	CA00140Q40P6	60	6	CH00060Q40P6
140	3	CSS0140Q40P3		60	7	CH00060Q40P7			
140	4	CSS0140Q40P4							

C-7

MOLE SINTERIZZATE  
SINTERED DIAMOND WHEELS



# CNC

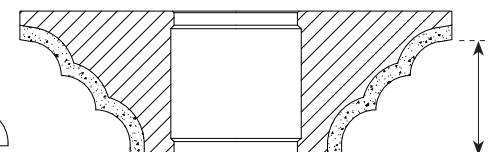
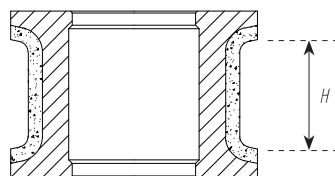

## DIAMANTATO

## ABRASIVO TRADIZIONALE

## HIGH LIFE TECHNOLOGY

### T20

Ø	POS	CODICE	TIPO	Ø	POS	CODICE	ØMIN	POS	CODICE
80	1	CSS0080T20P1	SETTORI	80	5	CA00080T20P5	60	5	CH00060T20P5
80	2	CSC0080T20P2	CORONA CONTINUA	80	6	CA00080T20P6	60	6	CH00060T20P6
80	3	CSC0080T20P3		60	7	CH00060T20P7			
80	4	CSC0080T20P4							

### T30

Ø	POS	CODICE	TIPO	Ø	POS	CODICE	ØMIN	POS	CODICE
80	1	CSS0080T30P1	SETTORI	80	5	CA00080T30P5	60	5	CH00060T30P5
80	2	CSC0080T30P2	CORONA CONTINUA	80	6	CA00080T30P6	60	6	CH00060T30P6
80	3	CSC0080T30P3		60	7	CH00060T30P7			
80	4	CSC0080T30P4							

### T40

Ø	POS	CODICE	TIPO	Ø	POS	CODICE	ØMIN	POS	CODICE
80	1	CSS0080T40P1	SETTORI	80	5	CA00080T40P5	60	5	CH00060T40P5
80	2	CSC0080T40P2	CORONA CONTINUA	80	6	CA00080T40P6	60	6	CH00060T40P6
80	3	CSC0080T40P3		60	7	CH00060T40P7			
80	4	CSC0080T40P4							

## DIAMANTATO

## ABRASIVO TRADIZIONALE

## HIGH LIFE TECHNOLOGY

### TP20

Ø	POS	CODICE	TIPO	Ø	POS	CODICE	ØMIN	POS	CODICE
120	1	CSS120TP20P1	SETTORI	120	5	CA0120TP20P5	60	5	CH0060TP20P5
120	2	CSC120TP20P2	CORONA CONTINUA	120	6	CA0120TP20P6	60	6	CH0060TP20P6
120	3	CSC120TP20P3		60	7	CH0060TP20P7			
120	4	CSC120TP20P4							

### TP30

Ø	POS	CODICE	TIPO	Ø	POS	CODICE	ØMIN	POS	CODICE
120	1	CSS120TP30P1	SETTORI	120	5	CA0120TP30P5	60	5	CH0060TP30P5
120	2	CSC120TP30P2	CORONA CONTINUA	120	6	CA0120TP30P6	60	6	CH0060TP30P6
120	3	CSC120TP30P3		60	7	CH0060TP30P7			
120	4	CSC120TP30P4							

### TP40

Ø	POS	CODICE	TIPO	Ø	POS	CODICE	ØMIN	POS	CODICE
140	1	CSS140TP40P1	SETTORI	140	5	CA0140TP40P5	60	5	CH0060TP40P5
140	2	CSS140TP40P2		140	6	CA0140TP40P6	60	6	CH0060TP40P6
140	3	CSS140TP40P3		60	7	CH0060TP40P7			
140	4	CSS140TP40P4							

C-8

MOLE SINTERIZZATE  
SINTERED DIAMOND WHEELS

# CNC

TRAP

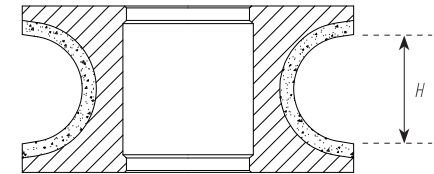
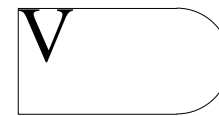
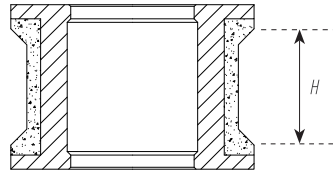

## DIAMANTATO

## ABRASIVO TRADIZIONALE

## HIGH LIFE TECHNOLOGY

### TRAP20

Ø	POS	CODICE	TIPO	Ø	POS	CODICE	ØMIN	POS	CODICE
80	1	CSS80TRP20P1	SETTORI	80	5	CA80TRP20P5	60	5	CH060TRP20P5
80	2	CSC80TRP20P2	CORONA CONTINUA	80	6	CA80TRP20P6	60	6	CH060TRP20P6
80	3	CSC80TRP20P3		60	7	CH060TRP20P7			
80	4	CSC80TRP20P4							

### TRAP30

Ø	POS	CODICE	TIPO	Ø	POS	CODICE	ØMIN	POS	CODICE
80	1	CSS80TRP30P1	SETTORI	80	5	CA80TRP30P5	60	5	CH060TRP30P5
80	2	CSC80TRP30P2	CORONA CONTINUA	80	6	CA80TRP30P6	60	6	CH060TRP30P6
80	3	CSC80TRP30P3		60	7	CH060TRP30P7			
80	4	CSC80TRP30P4							

### TRAP40

Ø	POS	CODICE	TIPO	Ø	POS	CODICE	ØMIN	POS	CODICE
80	1	CSS80TRP40P1	SETTORI	80	5	CA80TRP40P5	60	5	CH060TRP40P5
80	2	CSC80TRP40P2	CORONA CONTINUA	80	6	CA80TRP40P6	60	6	CH060TRP40P6
80	3	CSC80TRP40P3		60	7	CH060TRP40P7			
80	4	CSC80TRP40P4							

## DIAMANTATO

## ABRASIVO TRADIZIONALE

## HIGH LIFE TECHNOLOGY

### V20

Ø	POS	CODICE	TIPO	Ø	POS	CODICE	ØMIN	POS	CODICE
120	1	CSS0120V20P1	SETTORI	120	5	CA00120V20P5	60	5	CH00060V20P5
120	2	CSC0120V20P2	CORONA CONTINUA	120	6	CA00120V20P6	60	6	CH00060V20P6
120	3	CSC0120V20P3		60	7	CH00060V20P7			
120	4	CSC0120V20P4							

### V30

Ø	POS	CODICE	TIPO	Ø	POS	CODICE	ØMIN	POS	CODICE
120	1	CSS0120V30P1	SETTORI	120	5	CA00120V30P5	60	5	CH00060V30P5
120	2	CSC0120V30P2	CORONA CONTINUA	120	6	CA00120V30P6	60	6	CH00060V30P6
120	3	CSC0120V30P3		60	7	CH00060V30P7			
120	4	CSC0120V30P4							

### V40

Ø	POS	CODICE	TIPO	Ø	POS	CODICE	ØMIN	POS	CODICE
120	1	CSS0120V40P1	SETTORI	120	5	CA00120V40P5	60	5	CH00060Q40P5
120	2	CSC0120V40P2	CORONA CONTINUA	120	6	CA00120V40P6	60	6	CH00060Q40P6
120	3	CSC0120V40P3		60	7	CH00060Q40P7			
120	4	CSC0120V40P4							

C-9

MOLE SINTERIZZATE  
SINTERED DIAMOND WHEELS

# CNC

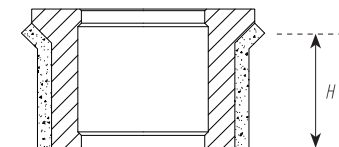
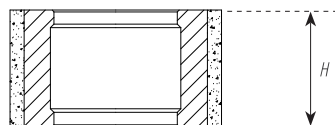

## DIAMANTATO

## ABRASIVO TRADIZIONALE

## HIGH LIFE TECHNOLOGY

### Z20

Ø	POS	CODICE	TIPO	Ø	POS	CODICE	ØMIN	POS	CODICE
80	1	CSS0080Z20P1	SETTORI	80	5	CA00080Z20P5	60	5	CH00060Z20P5
80	2	CSC0080Z20P2	CORONA CONTINUA	80	6	CA00080Z20P6	60	6	CH00060Z20P6
80	3	CSC0080Z20P3		60	7	CH00060Z20P7			
80	4	CSC0080Z20P4							

### Z30

Ø	POS	CODICE	TIPO	Ø	POS	CODICE	ØMIN	POS	CODICE
80	1	CSS0080Z30P1	SETTORI	80	5	CA00080Z30P5	60	5	CH00060Z30P5
80	2	CSC0080Z30P2	CORONA CONTINUA	80	6	CA00080Z30P6	60	6	CH00060Z30P6
80	3	CSC0080Z30P3		60	7	CH00060Z30P7			
80	4	CSC0080Z30P4							

### Z40

Ø	POS	CODICE	TIPO	Ø	POS	CODICE	ØMIN	POS	CODICE
80	1	CSS0080Z40P1	SETTORI	80	5	CA00080Z40P5	60	5	CH00060Z40P5
80	2	CSC0080Z40P2	CORONA CONTINUA	80	6	CA00080Z40P6	60	6	CH00060Z40P6
80	3	CSC0080Z40P3		60	7	CH00060Z40P7			
80	4	CSC0080Z40P4							

## DIAMANTATO

## ABRASIVO TRADIZIONALE

## HIGH LIFE TECHNOLOGY

### Z20 UP

Ø	POS	CODICE	TIPO	Ø	POS	CODICE	ØMIN	POS	CODICE
80	1	CSS80ZSU20P1	SETTORI	80	5	CA080ZSU20P5	60	5	CH060ZSU20P5
80	2	CSC80ZSU20P2	CORONA CONTINUA	80	6	CA080ZSU20P6	60	6	CH060ZSU20P6
80	3	CSC80ZSU20P3		60	7	CH060ZSU20P7			
80	4	CSC80ZSU20P4							

### Z30 UP

Ø	POS	CODICE	TIPO	Ø	POS	CODICE	ØMIN	POS	CODICE
80	1	CSS80ZSU30P1	SETTORI	80	5	CA080ZSU30P5	60	5	CH060ZSU30P5
80	2	CSC80ZSU30P2	CORONA CONTINUA	80	6	CA080ZSU30P6	60	6	CH060ZSU30P6
80	3	CSC80ZSU30P3		60	7	CH060ZSU30P7			
80	4	CSC80ZSU30P4							

### Z40 UP

Ø	POS	CODICE	TIPO	Ø	POS	CODICE	ØMIN	POS	CODICE
80	1	CSS80ZSU40P1	SETTORI	80	5	CA080ZSU40P5	60	5	CH060ZSU40P5
80	2	CSC80ZSU40P2	CORONA CONTINUA	80	6	CA080ZSU40P6	60	6	CH060ZSU40P6
80	3	CSC80ZSU40P3		60	7	CH060ZSU40P7			
80	4	CSC80ZSU40P4							

C-10

MOLE SINTERIZZATE  
SINTERED DIAMOND WHEELS

# CNC

ZSDWN

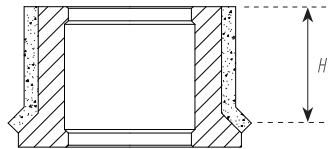

DIAMANTATO				ABRASIVO TRADIZIONALE			HIGH LIFE TECHNOLOGY		
<b>Z20 DOWN</b>									
Ø	POS	CODICE	TIPO	Ø	POS	CODICE	ØMIN	POS	CODICE
80	1	CSS80ZSD20P1	SETTORI	80	5	CA080ZSD20P5	60	5	CH060ZSD20P5
80	2	CSC80ZSD20P2	CORONA CONTINUA	80	6	CA080ZSD20P6	60	6	CH060ZSD20P6
80	3	CSC80ZSD20P3		60	7	CH060ZSD20P7			
80	4	CSC80ZSD20P4							
<b>Z30 DOWN</b>									
Ø	POS	CODICE	TIPO	Ø	POS	CODICE	ØMIN	POS	CODICE
80	1	CSS80ZSD30P1	SETTORI	80	5	CA080ZSD30P5	60	5	CH060ZSD30P5
80	2	CSC80ZSD30P2	CORONA CONTINUA	80	6	CA080ZSD30P6	60	6	CH060ZSD30P6
80	3	CSC80ZSD30P3		60	7	CH060ZSD30P7			
80	4	CSC80ZSD30P4							
<b>Z40 DOWN</b>									
Ø	POS	CODICE	TIPO	Ø	POS	CODICE	ØMIN	POS	CODICE
80	1	CSS80ZSD40P1	SETTORI	80	5	CA080ZSD40P5	60	5	CH060ZSD40P5
80	2	CSC80ZSD40P2	CORONA CONTINUA	80	6	CA080ZSD40P6	60	6	CH060ZSD40P6
80	3	CSC80ZSD40P3		60	7	CH060ZSD40P7			
80	4	CSC80ZSD40P4							

C-11

MOLE SINTERIZZATE  
SINTERED DIAMOND WHEELS

# CNC

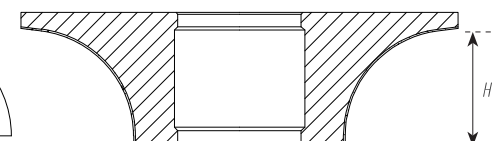
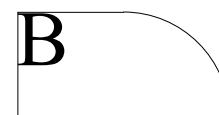
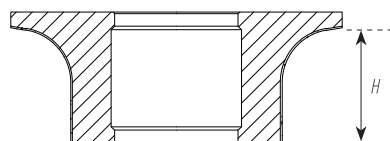

## DIAMANTATO

## ABRASIVO TRADIZIONALE

## HIGH LIFE TECHNOLOGY

### A20

Ø	POS	CODICE	TIPO	Ø	POS	CODICE	ØMIN	POS	CODICE
80	1	CEF0080A20G6	FRESATA	80	5	CA00080A20P5	60	5	CH00060A20P5
80	2	CEC080A20G13	CORONA CONTINUA	80	6	CA00080A20P6	60	6	CH00060A20P6
80	3	CEC080A20G17		60	7	CH00060A20P7			
80	4	CEC080A20G21							

### A30

Ø	POS	CODICE	TIPO	Ø	POS	CODICE	ØMIN	POS	CODICE
80	1	CEF0080A30G6	FRESATA	80	5	CA00080A30P5	60	5	CH00060A30P5
80	2	CEC080A30G13	CORONA CONTINUA	80	6	CA00080A30P6	60	6	CH00060A30P6
80	3	CEC080A30G17		60	7	CH00060A30P7			
80	4	CEC080A30G21							

### A40

Ø	POS	CODICE	TIPO	Ø	POS	CODICE	ØMIN	POS	CODICE
120	1	CEF0120A40G6	FRESATA	120	5	CA00120A40P5	60	5	CH00060A40P5
120	2	CEC120A40G13	CORONA CONTINUA	120	6	CA00120A40P6	60	6	CH00060A40P6
120	3	CEC120A40G17		60	7	CH00060A40P7			
120	4	CEC120A40G21							

## DIAMANTATO

## ABRASIVO TRADIZIONALE

## HIGH LIFE TECHNOLOGY

### B20

Ø	POS	CODICE	TIPO	Ø	POS	CODICE	ØMIN	POS	CODICE
80	1	CEF0080B20G6	FRESATA	80	5	CA00080B20P5	60	5	CH00060B20P5
80	2	CEC080B20G13	CORONA CONTINUA	80	6	CA00080B20P6	60	6	CH00060B20P6
80	3	CEC080B20G17		60	7	CH00060B20P7			
80	4	CEC080B20G21							

### B30

Ø	POS	CODICE	TIPO	Ø	POS	CODICE	ØMIN	POS	CODICE
120	1	CEF0120B30G6	FRESATA	120	5	CA00120B30P5	60	5	CH00060B30P5
120	2	CEC120B30G13	CORONA CONTINUA	120	6	CA00120B30P6	60	6	CH00060B30P6
120	3	CEC120B30G17		60	7	CH00060B30P7			
120	4	CEC120B30G21							

### B40

Ø	POS	CODICE	TIPO	Ø	POS	CODICE	ØMIN	POS	CODICE
140	1	CEF0140B40G6	FRESATA	140	5	CA00140B40P5	60	5	CH00060B40P5
140	2	CEC140B40G13	CORONA CONTINUA	140	6	CA00140B40P6	60	6	CH00060B40P6
140	3	CEC140B40G17		60	7	CH00060B40P7			
140	4	CEC140B40G21							

C-12

MOLE ELETTRODEPSTE  
ELECTROPLATED DIAMOND WHEELS



# CNC

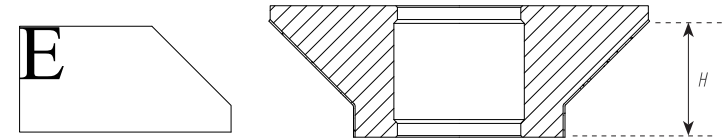
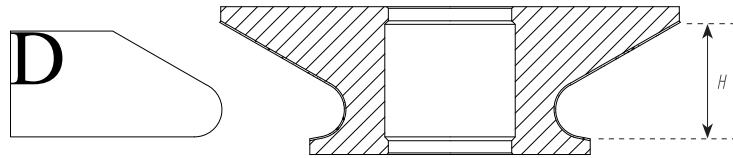

DIAMANTATO				ABRASIVO TRADIZIONALE				HIGH LIFE TECHNOLOGY			
<b>D20</b>											
Ø	POS	CODICE	TIPO	Ø	POS	CODICE		ØMIN	POS	CODICE	
120	1	CEF0120D20G6	FRESATA	120	5	CA00120D20P5		60	5	CH00060D20P5	
120	2	CEC120D20G13	CORONA CONTINUA	120	6	CA00120D20P6		60	6	CH00060D20P6	
120	3	CEC120D20G17		60	7	CH00060D20P7					
120	4	CEC120D20G21									
<b>D30</b>											
Ø	POS	CODICE	TIPO	Ø	POS	CODICE		ØMIN	POS	CODICE	
120	1	CEF0120D30G6	FRESATA	120	5	CA00120D30P5		60	5	CH00060D30P5	
120	2	CEC120D30G13	CORONA CONTINUA	120	6	CA00120D30P6		60	6	CH00060D30P6	
120	3	CEC120D30G17		60	7	CH00060D30P7					
120	4	CEC120D30G21									
<b>D40</b>											
Ø	POS	CODICE	TIPO	Ø	POS	CODICE		ØMIN	POS	CODICE	
140	1	CEF0140D40G6	FRESATA	140	5	CA00140D40P5		60	5	CH00060D40P5	
140	2	CEC140D40G13	CORONA CONTINUA	140	6	CA00140D40P6		60	6	CH00060D40P6	
140	3	CEC140D40G17		60	7	CH00060D40P7					
140	4	CEC140D40G21									

DIAMANTATO				ABRASIVO TRADIZIONALE				HIGH LIFE TECHNOLOGY			
<b>E20</b>											
Ø	POS	CODICE	TIPO	Ø	POS	CODICE		ØMIN	POS	CODICE	
80	1	CEF0080E20G6	FRESATA	80	5	CA00080E20P5		60	5	CH00060E20P5	
80	2	CEC080E20G13	CORONA CONTINUA	80	6	CA00080E20P6		60	6	CH00060E20P6	
80	3	CEC080E20G17		60	7	CH00060E20P7					
80	4	CEC080E20G21									
<b>E30</b>											
Ø	POS	CODICE	TIPO	Ø	POS	CODICE		ØMIN	POS	CODICE	
80	1	CEF0080E30G6	FRESATA	80	5	CA00080E30P5		60	5	CH00060E30P5	
80	2	CEC080E30G13	CORONA CONTINUA	80	6	CA00080E30P6		60	6	CH00060E30P6	
80	3	CEC080E30G17		60	7	CH00060E30P7					
80	4	CEC080E30G21									
<b>E40</b>											
Ø	POS	CODICE	TIPO	Ø	POS	CODICE		ØMIN	POS	CODICE	
80	1	CEF0080E40G6	FRESATA	80	5	CA00080E40P5		60	5	CH00060E40P5	
80	2	CEC080E40G13	CORONA CONTINUA	80	6	CA00080E40P6		60	6	CH00060E40P6	
80	3	CEC080E40G17		60	7	CH00060E40P7					
80	4	CEC080E40G21									

# CNC

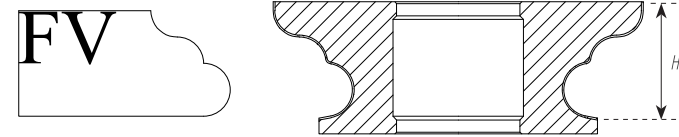
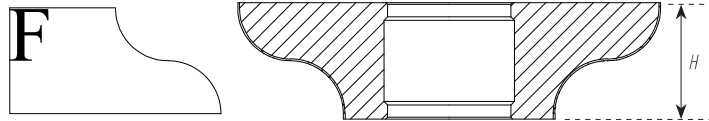

DIAMANTATO				ABRASIVO TRADIZIONALE				HIGH LIFE TECHNOLOGY			
<b>F20</b>											
Ø	POS	CODICE	TIPO	Ø	POS	CODICE		ØMIN	POS	CODICE	
120	1	CEF0120F20G6	FRESATA	120	5	CA00120F20P5		60	5	CH00060F20P5	
120	2	CEC120F20G13	CORONA CONTINUA	120	6	CA00120F20P6		60	6	CH00060F20P6	
120	3	CEC120F20G17		60	7	CH00060F20P7					
120	4	CEC120F20G21									
<b>F30</b>											
Ø	POS	CODICE	TIPO	Ø	POS	CODICE		ØMIN	POS	CODICE	
120	1	CEF0120F30G6	FRESATA	120	5	CA00120F30P5		60	5	CH00060F30P5	
120	2	CEC120F30G13	CORONA CONTINUA	120	6	CA00120F30P6		60	6	CH00060F30P6	
120	3	CEC120F30G17		60	7	CH00060F30P7					
120	4	CEC120F30G21									
<b>F40</b>											
Ø	POS	CODICE	TIPO	Ø	POS	CODICE		ØMIN	POS	CODICE	
140	1	CEF0140F40G6	FRESATA	140	5	CA00140F40P5		60	5	CH00060F40P5	
140	2	CEC140F40G13	CORONA CONTINUA	140	6	CA00140F40P6		60	6	CH00060F40P6	
140	3	CEC140F40G17		60	7	CH00060F40P7					
140	4	CEC140F40G21									

DIAMANTATO				ABRASIVO TRADIZIONALE				HIGH LIFE TECHNOLOGY			
<b>FV20</b>											
Ø	POS	CODICE	TIPO	Ø	POS	CODICE		ØMIN	POS	CODICE	
120	1	CEF120FV20G6	FRESATA	120	5	CA0120FV20P5		60	5	CH0060FV20P5	
120	2	CEC120FV20G13	CORONA CONTINUA	120	6	CA0120FV20P6		60	6	CH0060FV20P6	
120	3	CEC120FV20G17		60	7	CH0060FV20P7					
120	4	CEC120FV20G21									
<b>FV30</b>											
Ø	POS	CODICE	TIPO	Ø	POS	CODICE		ØMIN	POS	CODICE	
120	1	CEF120FV30G6	FRESATA	120	5	CA0120FV30P5		60	5	CH0060FV30P5	
120	2	CEC120FV30G13	CORONA CONTINUA	120	6	CA0120FV30P6		60	6	CH0060FV30P6	
120	3	CEC120FV30G17		60	7	CH0060FV30P7					
120	4	CEC120FV30G21									
<b>FV40</b>											
Ø	POS	CODICE	TIPO	Ø	POS	CODICE		ØMIN	POS	CODICE	
120	1	CEF120FV40G6	FRESATA	120	5	CA0120FV40P5		60	5	CH0060FV40P5	
120	2	CEC120FV40G13	CORONA CONTINUA	120	6	CA0120FV40P6		60	6	CH0060FV40P6	
120	3	CEC120FV40G17		60	7	CH0060FV40P7					
120	4	CEC120FV40G21									

C-14

MOLE ELETTRODEPSTE  
ELECTROPLATED DIAMOND WHEELS

# CNC

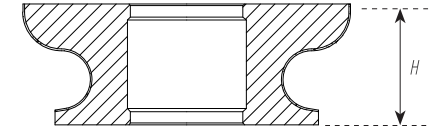
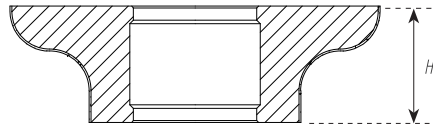

DIAMANTATO				ABRASIVO TRADIZIONALE				HIGH LIFE TECHNOLOGY			
<b>FZ20</b>											
Ø	POS	CODICE	TIPO	Ø	POS	CODICE		ØMIN	POS	CODICE	
120	1	CEF120FZ20G6	FRESATA	120	5	CA0120FZ20P5		60	5	CH0060FZ20P5	
120	2	CEC120FZ20G13	CORONA CONTINUA	120	6	CA0120FZ20P6		60	6	CH0060FZ20P6	
120	3	CEC120FZ20G17		60	7	CH0060FZ20P7					
120	4	CEC120FZ20G21									
<b>FZ30</b>											
Ø	POS	CODICE	TIPO	Ø	POS	CODICE		ØMIN	POS	CODICE	
120	1	CEF120FZ30G6	FRESATA	120	5	CA0120FZ30P5		60	5	CH0060FZ30P5	
120	2	CEC120FZ30G13	CORONA CONTINUA	120	6	CA0120FZ30P6		60	6	CH0060FZ30P6	
120	3	CEC120FZ30G17		60	7	CH0060FZ30P7					
120	4	CEC120FZ30G21									
<b>FZ40</b>											
Ø	POS	CODICE	TIPO	Ø	POS	CODICE		ØMIN	POS	CODICE	
120	1	CEF120FZ40G6	FRESATA	120	5	CA0120FZ40P5		60	5	CH0060FZ40P5	
120	2	CEC120FZ40G13	CORONA CONTINUA	120	6	CA0120FZ40P6		60	6	CH0060FZ40P6	
120	3	CEC120FZ40G17		60	7	CH0060FZ40P7					
120	4	CEC120FZ40G21									

DIAMANTATO				ABRASIVO TRADIZIONALE				HIGH LIFE TECHNOLOGY			
<b>G20</b>											
Ø	POS	CODICE	TIPO	Ø	POS	CODICE		ØMIN	POS	CODICE	
120	1	CEF0120G20G6	FRESATA	120	5	CA00120G20P5		60	5	CH00060G20P5	
120	2	CEC120G20G13	CORONA CONTINUA	120	6	CA00120G20P6		60	6	CH00060G20P6	
120	3	CEC120G20G17		60	7	CH00060G20P7					
120	4	CEC120G20G21									
<b>G30</b>											
Ø	POS	CODICE	TIPO	Ø	POS	CODICE		ØMIN	POS	CODICE	
120	1	CEF0120G30G6	FRESATA	120	5	CA00120G30P5		60	5	CH00060G30P5	
120	2	CEC120G30G13	CORONA CONTINUA	120	6	CA00120G30P6		60	6	CH00060G30P6	
120	3	CEC120G30G17		60	7	CH00060G30P7					
120	4	CEC120G30G21									
<b>G40</b>											
Ø	POS	CODICE	TIPO	Ø	POS	CODICE		ØMIN	POS	CODICE	
120	1	CEF0120G40G6	FRESATA	120	5	CA00120G40P5		60	5	CH00060G40P5	
120	2	CEC120G40G13	CORONA CONTINUA	120	6	CA00120G40P6		60	6	CH00060G40P6	
120	3	CEC120G40G17		60	7	CH00060G40P7					
120	4	CEC120G40G21									

# CNC

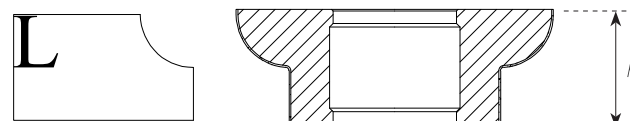
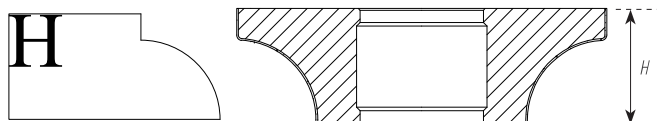

DIAMANTATO				ABRASIVO TRADIZIONALE				HIGH LIFE TECHNOLOGY			
<b>H20</b>											
Ø	POS	CODICE	TIPO	Ø	POS	CODICE		ØMIN	POS	CODICE	
120	1	CEF0120H20G6	FRESATA	120	5	CA00120H20P5		60	5	CH00060H20P5	
120	2	CEC120H20G13	CORONA CONTINUA	120	6	CA00120H20P6		60	6	CH00060H20P6	
120	3	CEC120H20G17		60	7	CH00060H20P7					
120	4	CEC120H20G21									
<b>H30</b>											
Ø	POS	CODICE	TIPO	Ø	POS	CODICE		ØMIN	POS	CODICE	
120	1	CEF0120H30G6	FRESATA	120	5	CA00120H30P5		60	5	CH00060H30P5	
120	2	CEC120H30G13	CORONA CONTINUA	120	6	CA00120H30P6		60	6	CH00060H30P6	
120	3	CEC120H30G17		60	7	CH00060H30P7					
120	4	CEC120H30G21									
<b>H40</b>											
Ø	POS	CODICE	TIPO	Ø	POS	CODICE		ØMIN	POS	CODICE	
140	1	CEF0120H40G6	FRESATA	140	5	CA00140H40P5		60	5	CH00060H40P5	
140	2	CEC120H40G13	CORONA CONTINUA	140	6	CA00140H40P6		60	6	CH00060H40P6	
140	3	CEC120H40G17		60	7	CH00060H40P7					
140	4	CEC120H40G21									

DIAMANTATO				ABRASIVO TRADIZIONALE				HIGH LIFE TECHNOLOGY			
<b>L20</b>											
Ø	POS	CODICE	TIPO	Ø	POS	CODICE		ØMIN	POS	CODICE	
120	1	CEF0120L20G6	FRESATA	120	5	CA00120L20P5		60	5	CH00060L20P5	
120	2	CEC120L20G13	CORONA CONTINUA	120	6	CA00120L20P6		60	6	CH00060L20P6	
120	3	CEC120L20G17		60	7	CH00060L20P7					
120	4	CEC120L20G21									
<b>L30</b>											
Ø	POS	CODICE	TIPO	Ø	POS	CODICE		ØMIN	POS	CODICE	
120	1	CEF0120L30G6	FRESATA	120	5	CA00120L30P5		60	5	CH00060L30P5	
120	2	CEC120L30G13	CORONA CONTINUA	120	6	CA00120L30P6		60	6	CH00060L30P6	
120	3	CEC120L30G17		60	7	CH00060L30P7					
120	4	CEC120L30G21									
<b>L40</b>											
Ø	POS	CODICE	TIPO	Ø	POS	CODICE		ØMIN	POS	CODICE	
140	1	CEF0140L40G6	FRESATA	140	5	CA00140L40P5		60	5	CH00060L40P5	
140	2	CEC140L40G13	CORONA CONTINUA	140	6	CA00140L40P6		60	6	CH00060L40P6	
140	3	CEC140L40G17		60	7	CH00060L40P7					
140	4	CEC140L40G21									

C-16

MOLE ELETTRODEPSTE  
ELECTROPLATED DIAMOND WHEELS

# CNC

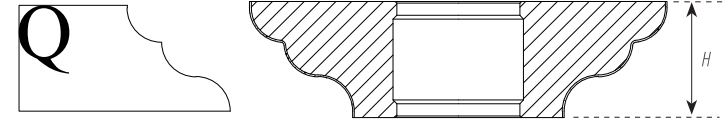
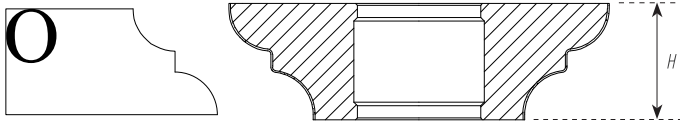

DIAMANTATO				ABRASIVO TRADIZIONALE				HIGH LIFE TECHNOLOGY			
<b>O20</b>											
Ø	POS	CODICE	TIPO	Ø	POS	CODICE		ØMIN	POS	CODICE	
120	1	CEF0120020G6	FRESATA	120	5	CA00120020P5		60	5	CH00060020P5	
120	2	CEC120020G13	CORONA CONTINUA	120	6	CA00120020P6		60	6	CH00060020P6	
120	3	CEC120020G17		60	7	CH00060020P7					
120	4	CEC120020G21									
<b>O30</b>											
Ø	POS	CODICE	TIPO	Ø	POS	CODICE		ØMIN	POS	CODICE	
120	1	CEF0120030G6	FRESATA	120	5	CA00120030P5		60	5	CH00060030P5	
120	2	CEC120030G13	CORONA CONTINUA	120	6	CA00120030P6		60	6	CH00060030P6	
120	3	CEC120030G17		60	7	CH00060030P7					
120	4	CEC120030G21									
<b>O40</b>											
Ø	POS	CODICE	TIPO	Ø	POS	CODICE		ØMIN	POS	CODICE	
120	1	CEF0120040G6	FRESATA	120	5	CA00120040P5		60	5	CH00060040P5	
120	2	CEC120040G13	CORONA CONTINUA	120	6	CA00120040P6		60	6	CH00060040P6	
120	3	CEC120040G17		60	7	CH00060040P7					
120	4	CEC120040G21									

DIAMANTATO				ABRASIVO TRADIZIONALE				HIGH LIFE TECHNOLOGY			
<b>Q20</b>											
Ø	POS	CODICE	TIPO	Ø	POS	CODICE		ØMIN	POS	CODICE	
120	1	CEF0120Q20G6	FRESATA	120	5	CA00120Q20P5		60	5	CH00060Q20P5	
120	2	CEC120Q20G13	CORONA CONTINUA	120	6	CA00120Q20P6		60	6	CH00060Q20P6	
120	3	CEC120Q20G17		60	7	CH00060Q20P7					
120	4	CEC120Q20G21									
<b>Q30</b>											
Ø	POS	CODICE	TIPO	Ø	POS	CODICE		ØMIN	POS	CODICE	
120	1	CEF0120Q30G6	FRESATA	120	5	CA00120Q30P5		60	5	CH00060Q30P5	
120	2	CEC120Q30G13	CORONA CONTINUA	120	6	CA00120Q30P6		60	6	CH00060Q30P6	
120	3	CEC120Q30G17		60	7	CH00060Q30P7					
120	4	CEC120Q30G21									
<b>Q40</b>											
Ø	POS	CODICE	TIPO	Ø	POS	CODICE		ØMIN	POS	CODICE	
140	1	CEF0140Q40G6	FRESATA	140	5	CA00140Q40P5		60	5	CH00060Q40P5	
140	2	CEC140Q40G13	CORONA CONTINUA	140	6	CA00140Q40P6		60	6	CH00060Q40P6	
140	3	CEC140Q40G17		60	7	CH00060Q40P7					
140	4	CEC140Q40G21									



# CNC

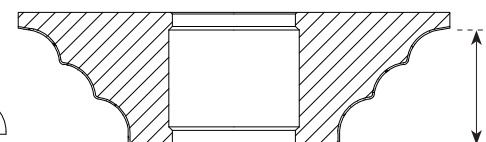
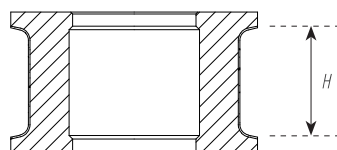
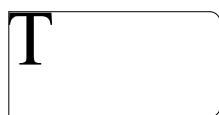

## DIAMANTATO

## ABRASIVO TRADIZIONALE

## HIGH LIFE TECHNOLOGY

### T20

Ø	POS	CODICE	TIPO	Ø	POS	CODICE	ØMIN	POS	CODICE
80	1	CEF0820T20G6	FRESATA	80	5	CA00080T20P5	60	5	CH00060T20P5
80	2	CEC080T20G13	CORONA CONTINUA	80	6	CA00080T20P6	60	6	CH00060T20P6
80	3	CEC080T20G17		60	7	CH00060T20P7			
80	4	CEC080T20G21							

### T30

Ø	POS	CODICE	TIPO	Ø	POS	CODICE	ØMIN	POS	CODICE
80	1	CEF0080T30G6	FRESATA	80	5	CA00080T30P5	60	5	CH00060T30P5
80	2	CEC080T30G13	CORONA CONTINUA	80	6	CA00080T30P6	60	6	CH00060T30P6
80	3	CEC080T30G17		60	7	CH00060T30P7			
80	4	CEC080T30G21							

### T40

Ø	POS	CODICE	TIPO	Ø	POS	CODICE	ØMIN	POS	CODICE
80	1	CEF0080T40G6	FRESATA	80	5	CA00080T40P5	60	5	CH00060T40P5
80	2	CEC080T40G13	CORONA CONTINUA	80	6	CA00080T40P6	60	6	CH00060T40P6
80	3	CEC080T40G17		60	7	CH00060T40P7			
80	4	CEC080T40G21							

## DIAMANTATO

## ABRASIVO TRADIZIONALE

## HIGH LIFE TECHNOLOGY

### TP20

Ø	POS	CODICE	TIPO	Ø	POS	CODICE	ØMIN	POS	CODICE
120	1	CEF120TP20G6	FRESATA	120	5	CA0120TP20P5	60	5	CH0060TP20P5
120	2	CEC120TP20G13	CORONA CONTINUA	120	6	CA0120TP20P6	60	6	CH0060TP20P6
120	3	CEC120TP20G17		60	7	CH0060TP20P7			
120	4	CEC120TP20G21							

### TP30

Ø	POS	CODICE	TIPO	Ø	POS	CODICE	ØMIN	POS	CODICE
120	1	CEF120TP30G6	FRESATA	120	5	CA0120TP30P5	60	5	CH0060TP30P5
120	2	CEC120TP30G13	CORONA CONTINUA	120	6	CA0120TP30P6	60	6	CH0060TP30P6
120	3	CEC120TP30G17		60	7	CH0060TP30P7			
120	4	CEC120TP30G21							

### TP40

Ø	POS	CODICE	TIPO	Ø	POS	CODICE	ØMIN	POS	CODICE
140	1	CEF140TP40G6	FRESATA	140	5	CA0140TP40P5	60	5	CH0060TP40P5
140	2	CEC140TP40G13	CORONA CONTINUA	140	6	CA0140TP40P6	60	6	CH0060TP40P6
140	3	CEC140TP40G17		60	7	CH0060TP40P7			
140	4	CEC140TP40G21							

C-18

MOLE ELETTRODEPSTE  
ELECTROPLATED DIAMOND WHEELS

# CNC

TRAP

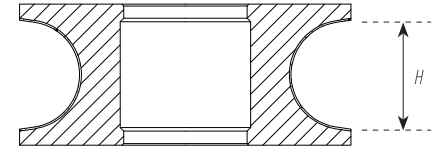
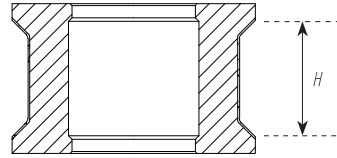

DIAMANTATO				ABRASIVO TRADIZIONALE			HIGH LIFE TECHNOLOGY		
<b>TRAP20</b>									
Ø	POS	CODICE	TIPO	Ø	POS	CODICE	ØMIN	POS	CODICE
80	1	CEF80TRP20G6	FRESATA	80	5	CA80TRP20P5	60	5	CH060TRP20P5
80	2	CEC80TRP20G13	CORONA CONTINUA	80	6	CA80TRP20P6	60	6	CH060TRP20P6
80	3	CEC80TRP20G17		60	7	CH060TRP20P7			
80	4	CEC80TRP20G21							
<b>TRAP30</b>									
Ø	POS	CODICE	TIPO	Ø	POS	CODICE	ØMIN	POS	CODICE
80	1	CEF80TRP30G6	FRESATA	80	5	CA80TRP30P5	60	5	CH060TRP30P5
80	2	CEC80TRP30G13	CORONA CONTINUA	80	6	CA80TRP30P6	60	6	CH060TRP30P6
80	3	CEC80TRP30G17		60	7	CH060TRP30P7			
80	4	CEC80TRP30G21							
<b>TRAP40</b>									
Ø	POS	CODICE	TIPO	Ø	POS	CODICE	ØMIN	POS	CODICE
80	1	CEF80TRP40G6	FRESATA	80	5	CA80TRP40P5	60	5	CH060TRP40P5
80	2	CEC80TRP40G13	CORONA CONTINUA	80	6	CA80TRP40P6	60	6	CH060TRP40P6
80	3	CEC80TRP40G17		60	7	CH060TRP40P7			
80	4	CEC80TRP40G21							

DIAMANTATO				ABRASIVO TRADIZIONALE			HIGH LIFE TECHNOLOGY		
<b>Q20</b>									
Ø	POS	CODICE	TIPO	Ø	POS	CODICE	ØMIN	POS	CODICE
120	1	CEF0120V20G6	FRESATA	120	5	CA00120V20P5	60	5	CH00060V20P5
120	2	CEC120V20G13	CORONA CONTINUA	120	6	CA00120V20P6	60	6	CH00060V20P6
120	3	CEC120V20G17		60	7	CH00060V20P7			
120	4	CEC120V20G21							
<b>Q30</b>									
Ø	POS	CODICE	TIPO	Ø	POS	CODICE	ØMIN	POS	CODICE
120	1	CEF0120V30G6	FRESATA	120	5	CA00120V30P5	60	5	CH00060V30P5
120	2	CEC120V30G13	CORONA CONTINUA	120	6	CA00120V30P6	60	6	CH00060V30P6
120	3	CEC120V30G17		60	7	CH00060V30P7			
120	4	CEC120V30G21							
<b>Q40</b>									
Ø	POS	CODICE	TIPO	Ø	POS	CODICE	ØMIN	POS	CODICE
120	1	CEF0120V40G6	FRESATA	120	5	CA00120V40P5	60	5	CH00060Q40P5
120	2	CEC120V40G13	CORONA CONTINUA	120	6	CA00120V40P6	60	6	CH00060Q40P6
120	3	CEC120V40G17		60	7	CH00060Q40P7			
120	4	CEC120V40G21							

# CNC

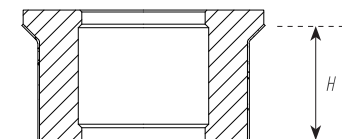
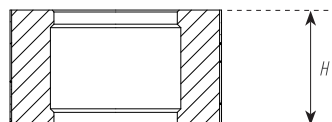

## DIAMANTATO

## ABRASIVO TRADIZIONALE

## HIGH LIFE TECHNOLOGY

### Z20

Ø	POS	CODICE	TIPO	Ø	POS	CODICE	ØMIN	POS	CODICE
80	1	CEF0080V20G6	FRESATA	80	5	CA00080Z20P5	60	5	CH00060Z20P5
80	2	CEC080V20G13	CORONA CONTINUA	80	6	CA00080Z20P6	60	6	CH00060Z20P6
80	3	CEC080V20G17		60	7	CH00060Z20P7			
80	4	CEC080V20G21							

### Z30

Ø	POS	CODICE	TIPO	Ø	POS	CODICE	ØMIN	POS	CODICE
80	1	CEF0080V30G6	FRESATA	80	5	CA00080Z30P5	60	5	CH00060Z30P5
80	2	CEC080V30G13	CORONA CONTINUA	80	6	CA00080Z30P6	60	6	CH00060Z30P6
80	3	CEC080V30G17		60	7	CH00060Z30P7			
80	4	CEC080V30G21							

### Z40

Ø	POS	CODICE	TIPO	Ø	POS	CODICE	ØMIN	POS	CODICE
80	1	CEF0080V40G6	FRESATA	80	5	CA00080Z40P5	60	5	CH00060Z40P5
80	2	CEC080V40G13	CORONA CONTINUA	80	6	CA00080Z40P6	60	6	CH00060Z40P6
80	3	CEC080V40G17		60	7	CH00060Z40P7			
80	4	CEC080V40G21							

## DIAMANTATO

## ABRASIVO TRADIZIONALE

## HIGH LIFE TECHNOLOGY

### ZS20 UP

Ø	POS	CODICE	TIPO	Ø	POS	CODICE	ØMIN	POS	CODICE
80	1	CEF80ZSU20G6	FRESATA	80	5	CA080ZSU20P5	60	5	CH060ZSU20P5
80	2	CEC80ZSU20G13	CORONA CONTINUA	80	6	CA080ZSU20P6	60	6	CH060ZSU20P6
80	3	CEC80ZSU20G17		60	7	CH060ZSU20P7			
80	4	CEC80ZSU20G21							

### ZS30 UP

Ø	POS	CODICE	TIPO	Ø	POS	CODICE	ØMIN	POS	CODICE
80	1	CEF80ZSD20G6	FRESATA	80	5	CA080ZSU30P5	60	5	CH060ZSU30P5
80	2	CEC80ZSD20G13	CORONA CONTINUA	80	6	CA080ZSU30P6	60	6	CH060ZSU30P6
80	3	CEC80ZSD20G17		60	7	CH060ZSU30P7			
80	4	CEC80ZSD20G21							

### ZS40 UP

Ø	POS	CODICE	TIPO	Ø	POS	CODICE	ØMIN	POS	CODICE
80	1	CEF80ZSU40G6	FRESATA	80	5	CA080ZSU40P5	60	5	CH060ZSU40P5
80	2	CEC80ZSU40G13	CORONA CONTINUA	80	6	CA080ZSU40P6	60	6	CH060ZSU40P6
80	3	CEC80ZSU40G17		60	7	CH060ZSU40P7			
80	4	CEC80ZSU40G21							

## C-20

MOLE ELETTRODEPSTE  
ELECTROPLATED DIAMOND WHEELS

# CNC

ZSDWN

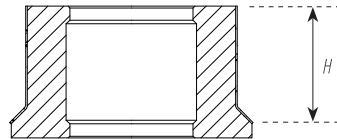

DIAMANTATO				ABRASIVO TRADIZIONALE			HIGH LIFE TECHNOLOGY		
<b>ZS20 DOWN</b>									
Ø	POS	CODICE	TIPO	Ø	POS	CODICE	ØMIN	POS	CODICE
80	1	CEF80ZSD20G6	FRESATA	80	5	CA080ZSD20P5	60	5	CH060ZSD20P5
80	2	CEC80ZSD20G13	CORONA CONTINUA	80	6	CA080ZSD20P6	60	6	CH060ZSD20P6
80	3	CEC80ZSD20G17		60	7	CH060ZSD20P7			
80	4	CEC80ZSD20G21							
<b>ZS30 DOWN</b>									
Ø	POS	CODICE	TIPO	Ø	POS	CODICE	ØMIN	POS	CODICE
80	1	CEF80ZSD30G6	FRESATA	80	5	CA080ZSD30P5	60	5	CH060ZSD30P5
80	2	CEC80ZSD30G13	CORONA CONTINUA	80	6	CA080ZSD30P6	60	6	CH060ZSD30P6
80	3	CEC80ZSD30G17		60	7	CH060ZSD30P7			
80	4	CEC80ZSD30G21							
<b>ZS40 DOWN</b>									
Ø	POS	CODICE	TIPO	Ø	POS	CODICE	ØMIN	POS	CODICE
80	1	CEF80ZSD40G6	FRESATA	80	5	CA080ZSD40P5	60	5	CH060ZSD40P5
80	2	CEC80ZSD40G13	CORONA CONTINUA	80	6	CA080ZSD40P6	60	6	CH060ZSD40P6
80	3	CEC80ZSD40G17		60	7	CH060ZSD40P7			
80	4	CEC80ZSD40G21							

# CNC

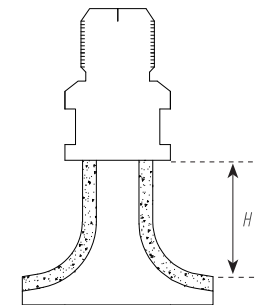
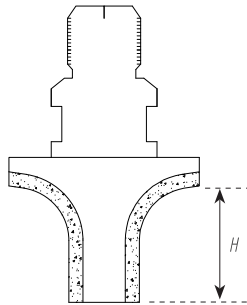
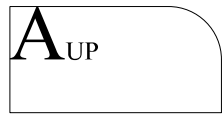

## DIAMANTE

## HIGH LIFE TECHNOLOGY

### A30UP

ØMIN	POS	CODICE	TIPO
20	1	CFSC20A30UP1	CORONA CONTINUA
20	2	CFSC20A30UP2	
20	3	CFSC20A30UP3	
20	4	CFSC20A30UP4	

ØMIN	POS	CODICE
20	5	CFH020A30UP5
20	6	CFH020A30UP6
20	7	CFH020A30UP7

### A40UP

ØMIN	POS	CODICE	TIPO
20	1	CFSC20A40UP1	CORONA CONTINUA
20	2	CFSC20A40UP2	
20	3	CFSC20A40UP3	
20	4	CFSC20A40UP4	

ØMIN	POS	CODICE
20	5	CFH020A40UP5
20	6	CFH020A40UP6
20	7	CFH020A40UP7

## DIAMANTE

## HIGH LIFE TECHNOLOGY

### A30DOWN

ØMIN	POS	CODICE	TIPO
20	1	CFSC20A30DP1	CORONA CONTINUA
20	2	CFSC20A30DP2	
20	3	CFSC20A30DP3	
20	4	CFSC20A30DP4	

ØMIN	POS	CODICE
20	5	CFH020A30DP5
20	6	CFH020A30DP6
20	7	CFH020A30DP7

### A40DOWN

ØMIN	POS	CODICE	TIPO
20	1	CFSC20A40DP1	CORONA CONTINUA
20	2	CFSC20A40DP2	
20	3	CFSC20A40DP3	
20	4	CFSC20A40DP4	

ØMIN	POS	CODICE
20	5	CFH020A40DP5
20	6	CFH020A40DP6
20	7	CFH020A40DP7

C-22

FRESE SINTERIZZATE  
SINTERED ROUTERS



# CNC

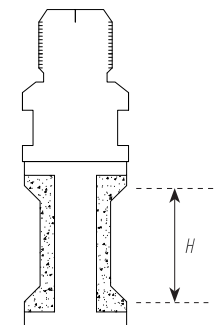
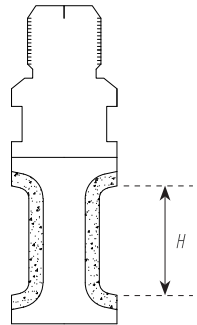
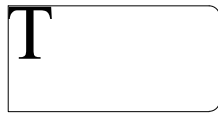

## DIAMANTE

## HIGH LIFE TECHNOLOGY

### T20

ØMIN	POS	CODICE	TIPO
20	1	CFSC020T20P1	CORONA CONTINUA
20	2	CFSC020T20P2	
20	3	CFSC020T20P3	
20	4	CFSC020T20P4	

ØMIN	POS	CODICE
20	5	CFH0020T20P5
20	6	CFH0020T20P6
20	7	CFH0020T20P7

### T30

ØMIN	POS	CODICE	TIPO
20	1	CFSC020T30P1	CORONA CONTINUA
20	2	CFSC020T30P2	
20	3	CFSC020T30P3	
20	4	CFSC020T30P4	

ØMIN	POS	CODICE
20	5	CFH0020T30P5
20	6	CFH0020T30P6
20	7	CFH0020T30P7

### T40

ØMIN	POS	CODICE	TIPO
20	1	CFSC020T40P1	CORONA CONTINUA
20	2	CFSC020T40P2	
20	3	CFSC020T40P3	
20	4	CFSC020T40P4	

ØMIN	POS	CODICE
20	5	CFH0020T40P5
20	6	CFH0020T40P6
20	7	CFH0020T40P7

## DIAMANTE

## HIGH LIFE TECHNOLOGY

### T20

ØMIN	POS	CODICE	TIPO
20	1	CFSC20TRP20P1	CORONA CONTINUA
20	2	CFSC20TRP20P2	
20	3	CFSC20TRP20P3	
20	4	CFSC20TRP20P4	

ØMIN	POS	CODICE
20	5	CFH20TRP20P5
20	6	CFH20TRP20P6
20	7	CFH20TRP20P7

### T30

ØMIN	POS	CODICE	TIPO
20	1	CFSC20TRP30P1	CORONA CONTINUA
20	2	CFSC20TRP30P2	
20	3	CFSC20TRP30P3	
20	4	CFSC20TRP30P4	

ØMIN	POS	CODICE
20	5	CFH20TRP30P5
20	6	CFH20TRP30P6
20	7	CFH20TRP30P7

### T40

ØMIN	POS	CODICE	TIPO
20	1	CFSC20TRP40P1	CORONA CONTINUA
20	2	CFSC20TRP40P2	
20	3	CFSC20TRP40P3	
20	4	CFSC20TRP40P4	

ØMIN	POS	CODICE
20	5	CFH20TRP40P5
20	6	CFH20TRP40P6
20	7	CFH20TRP40P7

# CNC

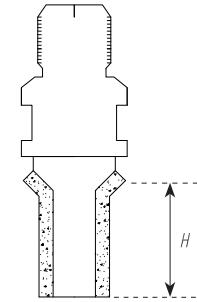
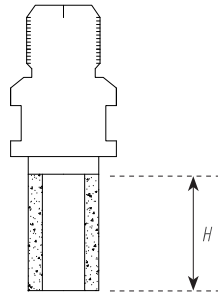
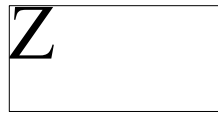

DIAMANTE

HIGH LIFE TECHNOLOGY

T20

ØMIN	POS	CODICE	TIPO	ØMIN	POS	CODICE
20	1	CFSC020Z45P1	CORONA CONTINUA	20	5	CFH0020Z45P5
20	2	CFSC020Z45P2		20	6	CFH0020Z45P6
20	3	CFSC020Z45P3		20	7	CFH0020Z45P7
20	4	CFSC020Z45P4				

DIAMANTE

HIGH LIFE TECHNOLOGY

ZS30UP

ØMIN	POS	CODICE	TIPO	ØMIN	POS	CODICE
20	1	CFSC20ZS30UP1	CORONA CONTINUA	20	5	CFH20ZS30UP5
20	2	CFSC20ZS30UP2		20	6	CFH20ZS30UP6
20	3	CFSC20ZS30UP3		20	7	CFH20ZS30UP7
20	4	CFSC20ZS30UP4				

ZS40UP

ØMIN	POS	CODICE	TIPO	ØMIN	POS	CODICE
20	1	CFSC20ZS40UP1	CORONA CONTINUA	20	5	CFH20ZS30UP5
20	2	CFSC20ZS40UP2		20	6	CFH20ZS30UP6
20	3	CFSC20ZS40UP3		20	7	CFH20ZS30UP7
20	4	CFSC20ZS40UP4				

C-24

FRESE SINTERIZZATE  
SINTERED ROUTERS

# CNC

ZSDWN

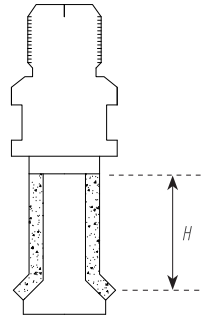

DIAMANTE

HIGH LIFE TECHNOLOGY

## ZS30DOWN

ØMIN	POS	TIPO	ØMIN	POS	TIPO
20	1	CFSC20ZS30DP1	20	5	CFH20ZS30DP5
20	2	CFSC20ZS30DP2	20	6	CFH20ZS30DP6
20	3	CFSC20ZS30DP3	20	7	CFH20ZS30DP7
20	4	CFSC20ZS30DP4			

## ZS40DOWN

ØMIN	POS	TIPO	ØMIN	POS	TIPO
20	1	CFSC20ZS40DP1	20	5	CFH20ZS30DP5
20	2	CFSC20ZS40DP2	20	6	CFH20ZS30DP6
20	3	CFSC20ZS40DP3	20	7	CFH20ZS30DP7
20	4	CFSC20ZS40DP4			

C-25

FRESE SINTERIZZATE  
SINTERED ROUTERS

# CNC

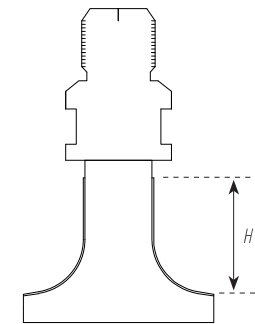
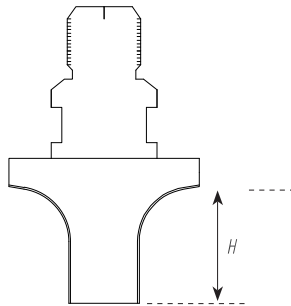
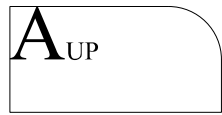

## DIAMANTE

## HIGH LIFE TECHNOLOGY

### A30UP

ØMIN	POS	CODICE	TIPO
20	1	CFEF20A30UG6	FRESATA
20	2	CFEC20A30UG13	CORONA CONTINUA
20	3	CFEC20A30UG17	
20	4	CFEC20A30UG21	

ØMIN	POS	CODICE
20	5	CFH020A30UP5
20	6	CFH020A30UP6
20	7	CFH020A30UP7

### A40UP

ØMIN	POS	CODICE	TIPO
20	1	CFEF20A40UG6F	FRESATA
20	2	CFEC20A40UG13C	CORONA CONTINUA
20	3	CFEC20A40UG17C	
20	4	CFEC20A40UG21C	

ØMIN	POS	CODICE
20	5	CFH020A40UP5
20	6	CFH020A40UP6
20	7	CFH020A40UP7

## DIAMANTE

## HIGH LIFE TECHNOLOGY

### A30DOWN

ØMIN	POS	CODICE	TIPO
20	1	CFEF20A30DG6	FRESATA
20	2	CFEC20A30DG13	CORONA CONTINUA
20	3	CFEC20A30DG17	
20	4	CFEC20A30DG21	

ØMIN	POS	CODICE
20	5	CFH020A30UP5
20	6	CFH020A30UP6
20	7	CFH020A30UP7

### A40DOWN

ØMIN	POS	CODICE	TIPO
20	1	CFEF20A40DG6	FRESATA
20	2	CFEC20A40DG13	CORONA CONTINUA
20	3	CFEC20A40DG17	
20	4	CFEC20A40DG21	

ØMIN	POS	CODICE
20	5	CFH020A40UP5
20	6	CFH020A40UP6
20	7	CFH020A40UP7

C-26

FRESE ELETTRODEPSTE  
ELECTROPLATED ROUTERS

# CNC

**T**

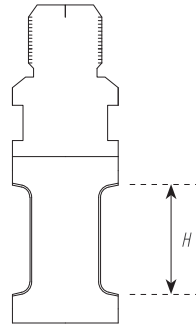

**TRAP**

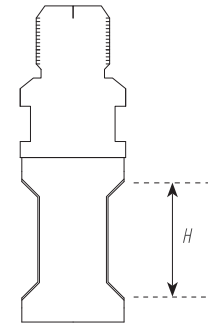

## DIAMANTE

## HIGH LIFE TECHNOLOGY

### T20

ØMIN	POS	CODICE	TIPO
20	1	CFEC020T20G6	FRESATA
20	2	CFEC20T20G13	CORONA CONTINUA
20	3	CFEC20T20G17	
20	4	CFEC20T20G21	

ØMIN	POS	CODICE
20	5	CFH0020T20P5
20	6	CFH0020T20P6
20	7	CFH0020T20P7

### T30

ØMIN	POS	CODICE	TIPO
20	1	CFEC020T30G6	FRESATA
20	2	CFEC20T30G13	CORONA CONTINUA
20	3	CFEC20T30G17	
20	4	CFEC20T30G21	

ØMIN	POS	CODICE
20	5	CFH0020T30P5
20	6	CFH0020T30P6
20	7	CFH0020T30P7

### T40

ØMIN	POS	CODICE	TIPO
20	1	CFEC020T40G6	FRESATA
20	2	CFEC20T40G13	CORONA CONTINUA
20	3	CFEC20T40G17	
20	4	CFEC20T40G21	

ØMIN	POS	CODICE
20	5	CFH0020T40P5
20	6	CFH0020T40P6
20	7	CFH0020T40P7

## DIAMANTE

## HIGH LIFE TECHNOLOGY

### T20

ØMIN	POS	CODICE	TIPO
20	1	CFEC20TRP20G6	FRESATA
20	2	CFEC20TRP20G13	CORONA CONTINUA
20	3	CFEC20TRP20G17	
20	4	CFEC20TRP20G21	

ØMIN	POS	CODICE
20	5	CFH20TRP20P5
20	6	CFH20TRP20P6
20	7	CFH20TRP20P7

### T30

ØMIN	POS	CODICE	TIPO
20	1	CFEC20TRP30G6	FRESATA
20	2	CFEC20TRP30G13	CORONA CONTINUA
20	3	CFEC20TRP30G17	
20	4	CFEC20TRP30G21	

ØMIN	POS	CODICE
20	5	CFH20TRP30P5
20	6	CFH20TRP30P6
20	7	CFH20TRP30P7

### T40

ØMIN	POS	CODICE	TIPO
20	1	CFEC20TRP40G6	FRESATA
20	2	CFEC20TRP40G13	CORONA CONTINUA
20	3	CFEC20TRP40G17	
20	4	CFEC20TRP40G21	

ØMIN	POS	CODICE
20	5	CFH20TRP40P5
20	6	CFH20TRP40P6
20	7	CFH20TRP40P7

C-27

FRESE ELETTRODEPSTE  
ELECTROPLATED ROUTERS



# CNC

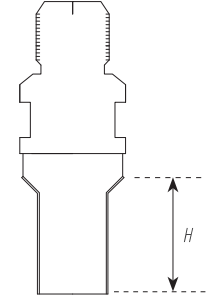
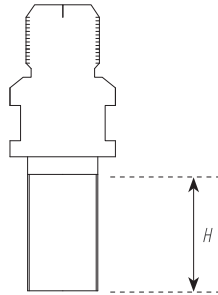
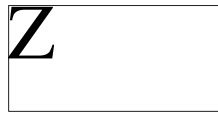

## DIAMANTE

## HIGH LIFE TECHNOLOGY

### T20

ØMIN	POS	CODICE	TIPO
0	1	CFEF020Z20G6	FRESATA
20	2	CFEC20Z20G13	CORONA CONTINUA
20	3	CFEC20Z20G17	
20	4	CFEC20Z20G21	

ØMIN	POS	CODICE
20	5	CFH0020Z45P5
20	6	CFH0020Z45P6
20	7	CFH0020Z45P7

## DIAMANTE

## HIGH LIFE TECHNOLOGY

### ZS30UP

ØMIN	POS	CODICE	TIPO
20	1	CFEF20ZS30UG6	FRESATA
20	2	CFEC20ZS30UG13	CORONA CONTINUA
20	3	CFEC20ZS30UG17	
20	4	CFEC20ZS30UG21	

ØMIN	POS	CODICE
20	5	CFH20ZS30UP5
20	6	CFH20ZS30UP6
20	7	CFH20ZS30UP7

### ZS40UP

ØMIN	POS	CODICE	TIPO
20	1	CFEF20ZS40UG6	FRESATA
20	2	CFEC20ZS40UG13	CORONA CONTINUA
20	3	CFEC20ZS40UG17	
20	4	CFEC20ZS40UG21	

ØMIN	POS	CODICE
20	5	CFH20ZS40UP5
20	6	CFH20ZS40UP6
20	7	CFH20ZS40UP7

C-28

FRESE ELETTRODEPOSTE  
ELECTROPLATED ROUTERS

# CNC

ZS<sub>DWN</sub>

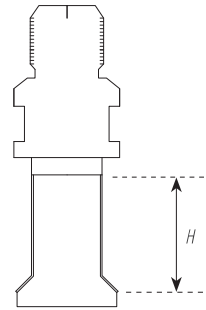

DIAMANTE

HIGH LIFE TECHNOLOGY

## ZS30DOWN

ØMIN	POS	CODICE	TIPO	ØMIN	POS	CODICE
20	1	CFEF20ZS30DG6	FRESATA	20	5	CFH20ZS30DP5
20	2	CFEC20ZS30DG13	CORONA CONTINUA	20	6	CFH20ZS30DP6
20	3	CFEC20ZS30DG17		20	7	CFH20ZS30DP7
20	4	CFEC20ZS30DG21				

## ZS40DOWN

ØMIN	POS	CODICE	TIPO	ØMIN	POS	CODICE
20	1	CFEF20ZS40DG6	FRESATA	20	5	CFH20ZS40DP5
20	2	CFEC20ZS40DG13	CORONA CONTINUA	20	6	CFH20ZS40DP6
20	3	CFEC20ZS40DG17		20	7	CFH20ZS40DP7
20	4	CFEC20ZS40DG21				

C-29

FRESE ELETTRORDEPOSTE  
ELECTROPLATED ROUTERS

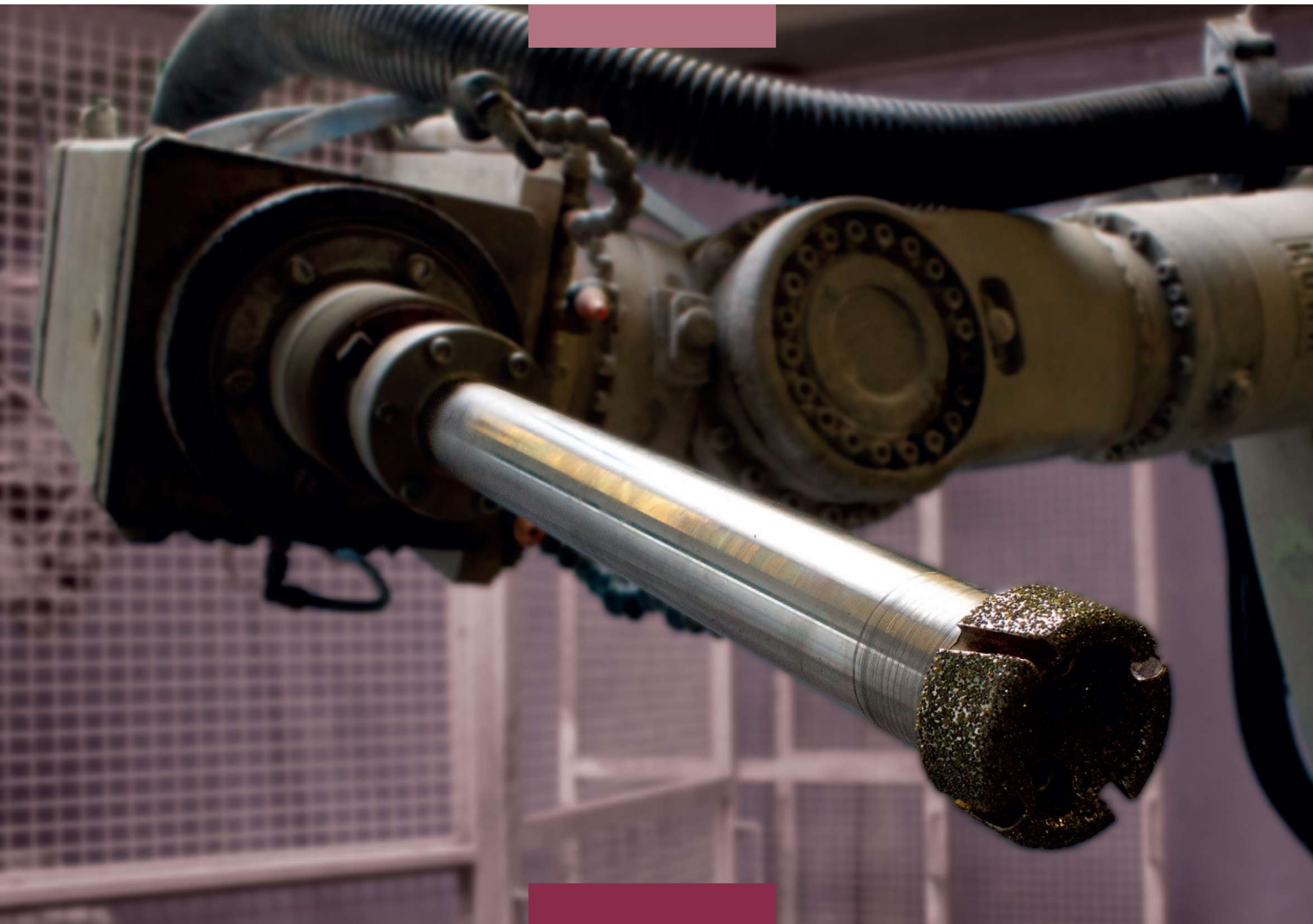

# Prolunghe *Extensions*

Prolunghe in acciaio per macchine a controllo numerico.

*Stainless steel extensions for numerical control machines.*

# Prolunghe *Extensions*



## CONO PORTAUTENSILE ISO40

### TOOLHOLDER ISO40 CONE

	CODICE	TIPO	ATTACCO	LUNGHEZZA
PC	PC00000040MG	ISO40	½ GAS	
	PC00000040FC		FLANGIA 6 FORI	25mm
	PC00000040FL		FLANGIA 6 FORI	75mm
	PC40PMF22L34		Ø22X34	34mm
	PC40PMF22L39		Ø22X39	39mm
	PC40PMF22L47		Ø22X47	47mm
	PC40PMF35L34		Ø35X34	34mm
	PC40PMF35L39		Ø35X39	39mm
	PC40PMF35L47		Ø35X47	47mm

## CONO PORTAUTENSILE ISO50

### TOOLHOLDER ISO50 CONE

	CODICE	TIPO	ATTACCO	LUNGHEZZA
PC	PC0000050MGC	ISO50	½ GAS	
	PC0000050FC		FLANGIA 6 FORI	25mm
	PC0000050FL		FLANGIA 6 FORI	75mm
	PC50PMF22L34		Ø22X34	34mm
	PC50PMF22L39		Ø22X39	39mm
	PC50PMF22L47		Ø22X47	47mm
	PC50PMF35L34		Ø35X34	34mm
	PC50PMF35L39		Ø35X39	39mm
	PC50PMF35L47		Ø35X47	47mm
	PC50PD12012F		PORTA DISCO	100mm

# Prolunghe *Extensions*

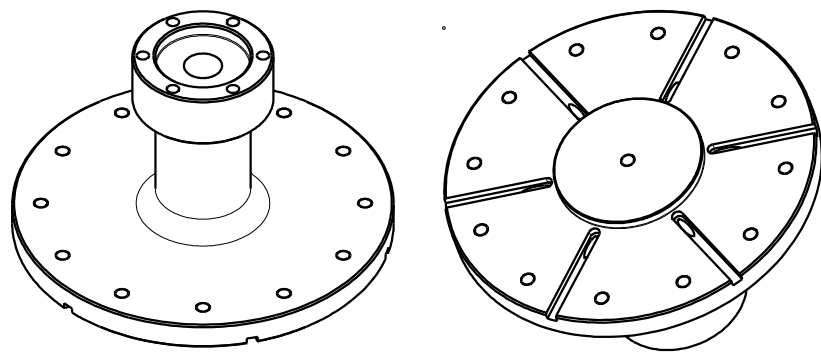

## PORTADISCO ATTACCO FLANGIA

### BLADE HOLDER FLANGE CONNECTION

	CODICE	Ø	HUT
PPD	PPD20012012M8	200	120



## PROLUNGA INOX FLANGIA/FLANGIA

### INOX EXTENSION FLANGE/FLANGE

	CODICE	HUT
PFF	PFF00000H150	150
	PFF00000H200	200
	PFF00000H250	250
	PFF00000H300	300



# Prolunghe *Extensions*



## PROLUNGA INOX FLANGIA/FLANGIA PICCOLA

### INOX EXTENSION FLANGE/SMALL FLANGE

	CODICE	HUT	TIPO ATTACCO	
PFFP	PFFP01503H10	150	3 HOLES Ø10	
	PFFP02003H10	200		
	PFFP03003H10	300		
	PFFP01503H14	150	3 HOLES Ø14	
	PFFP02003H14	200		
	PFFP03003H14	300		
	PFFP01502H20	150	2 HOLES Ø20	
	PFFP02002H20	200		
	PFFP03002H20	300		

## PROLUNGA INOX FLANGIA/ ½ GAS FEMMINA

### INOX EXTENSION FLANGE/ ½ GAS FEMALE

	CODICE	Ø	HUT	
PFMG	PFMG00030150	30	150	
	PFMG00030200		200	
	PFMG00030300		300	

# Prolunghe *Extensions*



## PROLUNGA INOX ½ GAS / ½ GAS FEMMINA

### INOX EXTENSION ½ GAS / ½ GAS FEMALE

	CODICE	Ø	HUT	
PMGM	PMGMG0003050	30	50	
	PMGMG0030100		100	
	PMGMG0030150		150	
	PMGMG0030200		200	

## PROLUNGA INOX ½ GAS / METRICA FEMMINA

### INOX EXTENSION ½ GAS / METRICAL CONNECTION FEMALE

	CODICE	FEMALE CONNECTION	Ø	HUT	
PMGM	PMGM10001850	M10	18	50	
	PMGM10001870			70	
	PMGM10018100			100	
	PMGM10018120			120	
	PMGM12001850	M12	18	50	
	PMGM12001870			70	
	PMGM12018100			100	
	PMGM12018120			120	
	PMGM14001850	M14	18	50	
	PMGM14001870			70	
	PMGM14018100			100	
	PMGM14018120			120	

# Prolunghe *Extensions*



PROLUNGA INOX ½ GAS/FLANGIA			
INOX EXTENSION ½ GAS/FLANGE			
	CODICE	HUT	
PMGF	PMGF00000H50	50	
	PMGF00000H80	80	
	PMGF0000H100	100	
	PMGF0000H120	120	



PROLUNGA INOX ½ GAS/FLANGIA PICCOLA			
INOX EXTENSION FLANGE/SMALL FLANGE			
	CODICE	HUT	TIPO ATTACCO
PMGFP	PMGFP0503H10	50	3 HOLES Ø10
	PMGFP0803H10	80	
	PMGFP1003H10	100	
	PMGFP1203H10	120	
	PMGFP0503H14	50	3 HOLES Ø14
	PMGFP0803H14	80	
	PMGFP1003H14	100	
	PMGFP1203H14	120	
	PMGFP0502H20	50	2 HOLES Ø20
	PMGFP0802H20	80	
	PMGFP1002H20	100	
	PMGFP1202H20	120	

# Prolunghe *Extensions*



## PORTAPUNTE COMPLETO INOX

### INOX COMPLETE POINT HOLDER

	CODICE	Ø	TIPO	
PPC	PPC00006ER16	6	ER16	
	PPC00008ER16	8		
	PPC00010ER16	10		
	PPC00006ER20	6	ER20	
	PPC00008ER20	8		
	PPC00010ER20	10		
	PPC00006ER25	6	ER25	
	PPC00008ER25	8		
	PPC00010ER25	10		
	PPC00006ER32	6	ER32	
	PPC00008ER32	8		
	PPC00010ER32	10		

## CORPO INOX PORTAPUNTE

### POINTHOLDER INOX BODY

	CODICE	TIPO	
PCPP	PCPP0000ER16	ER16	
	PCPP0000ER20	ER20	
	PCPP0000ER25	ER25	
	PCPP0000ER32	ER32	

# Prolunghe *Extensions*



**GHIERA DI BLOCCAGGIO PER PORTAPUNTE**

**POINTHOLDER LOCKING RING**

	<b>CODICE</b>	<b>TIPO</b>	
<b>PGPP</b>	PGPP0000ER16	ER16	
	PGPP0000ER20	ER20	
	PGPP0000ER25	ER25	
	PGPP0000ER32	ER32	



**PINZA IN ACCIAIO PER PORTAPUNTE**

**POINTHOLDER PINS**

	<b>CODICE</b>	<b>Ø</b>	<b>TIPO</b>	
<b>PPPP</b>	PPPP0006ER16	6	ER16	
	PPPP0008ER16	8		
	PPPP0010ER16	10		
	PPPP0006ER20	6	ER20	
	PPPP0008ER20	8		
	PPPP0010ER20	10		
	PPPP0006ER25	6	ER25	
	PPPP0008ER25	8		
	PPPP0010ER25	10		
	PPPP0006ER32	6	ER32	
	PPPP0008ER32	8		
	PPPP0010ER32	10		



— **Prolunghe** *Extensions* —



**P-9**







# Lucidatura *Polishing*

Frankfurt, fikert, virgole, piatti satellitari e anelli calibratori per la calibratura e la lucidatura di lastre e marmette di marmo e granito.

*Frankfurt, fikert, floating point, satellite plate and calibrating rings for the calibration and polishing marble and granite slabs and tiles.*

# Lucidatura *Polishing*



GR

PIATTO SATELLITARE A SETTORI PER GRANITO

SEGMENTED SATELLITE PLATE FOR GRANITE

	COD	Ø	GRANA
SG	LSG0150M45G9	150	50/60
	LSG150M45G10	150	60/70



GR

FIKERT DIAMANTATO PER GRANITO

SINTERED FIKERT FOR GRANITE

	COD	L	GRANA
FKRT	LFKRTD0140G9	140	50/60
	LFKRTD140G10	140	60/70
	LFKRTD140G12	140	70/80
	LFKRTD140G14	140	100/120
	LFKRTD140G16	140	140/170
	LFKRTD140G17	140	170/200

# Lucidatura *Polishing*



MR

**FRANKFURT A SETTORI PER MARMO**

**SEGMENTED FRANKFURT FOR MARBLE**

	<b>COD</b>	<b>N° SETTORI</b>	<b>GRANA</b>
<b>FKRFS</b>	LFRKFS0009G6	9	40/50
	LFRKFS0009G9	9	50/60
	LFRKFS009G11	9	60/80
	LFRKFS009G13	9	80/100
	LFRKFS009G14	9	100/120



MR

**FRANKFURT TIPO CITROEN PER MARMO**

**FRANKFURT CITROEN TYPE FOR MARBLE**

	<b>COD</b>	<b>GRANA</b>
<b>FKRFC</b>	LFRKFC0000G6	40/50
	LFRKFC0000G9	50/60
	LFRKFC0000G11	60/80
	LFRKFC0000G13	80/100
	LFRKFC0000G14	100/120





## **GS Diamant**

Via Aurelia, 65 - 54033 Carrara MS

Tel. +39 0585 832249

[www.gsdiamant.com](http://www.gsdiamant.com)  
[info@gsdiamant.com](mailto:info@gsdiamant.com)